

# 3400 Raymond-Lasnier



**MONTONI**

Building on our word  
for tomorrow



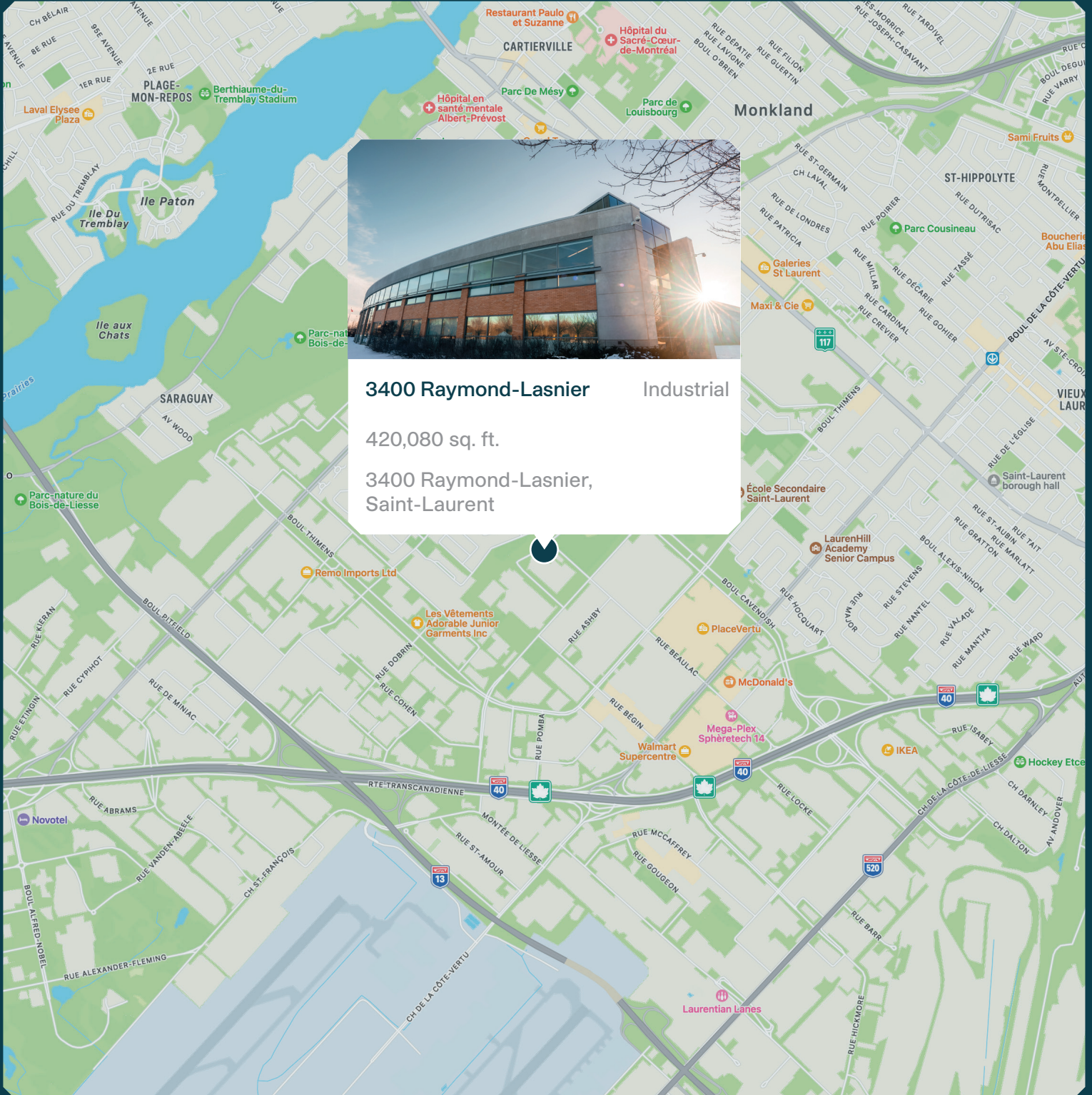

**3400 Raymond-Lasnier** Industrial

420,080 sq. ft.

3400 Raymond-Lasnier,  
Saint-Laurent



# Neighborhood Map

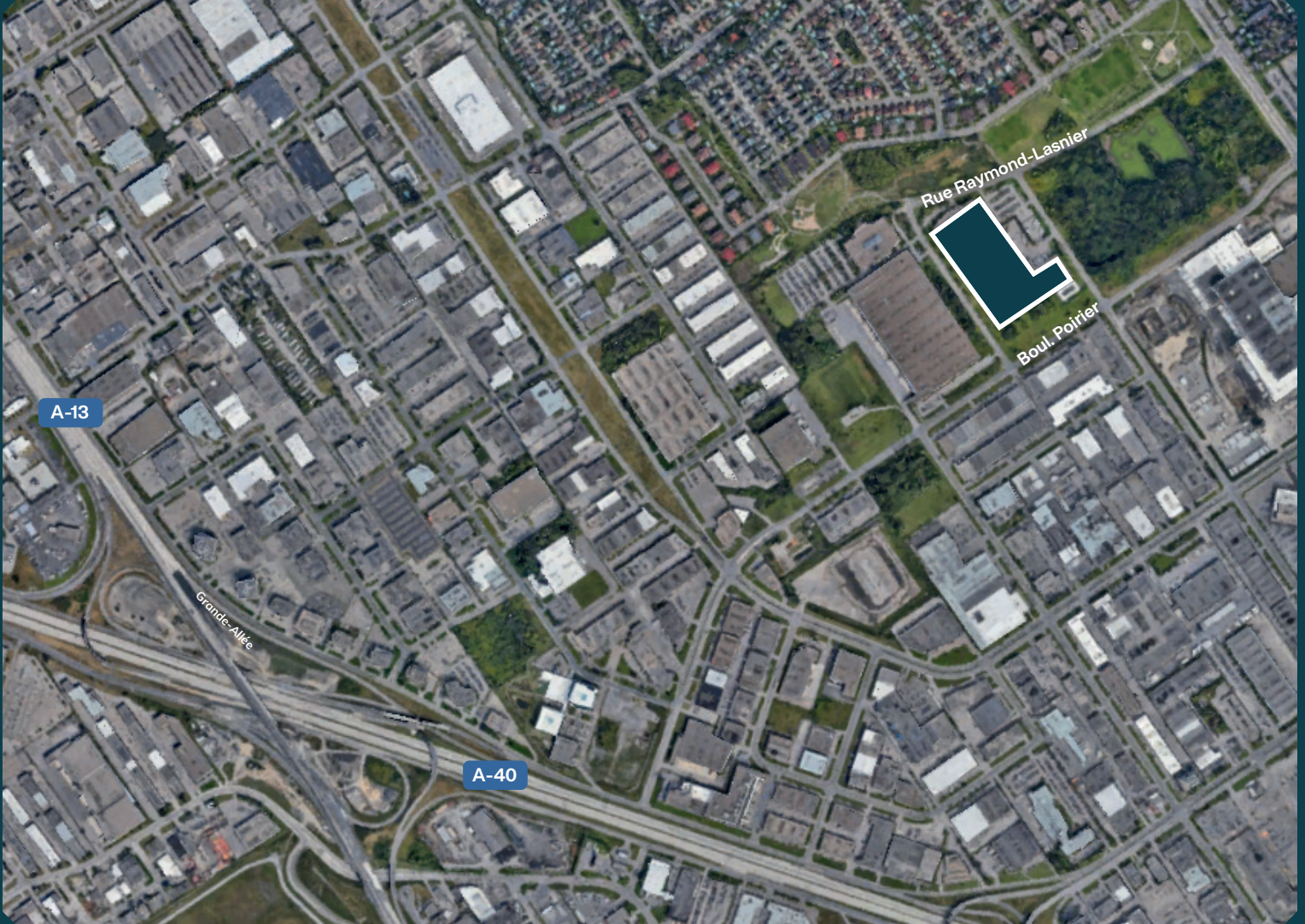

## LAND

Total area: 887,221 sq. ft

## BUILDING

Available space: 420,080 sq. ft.

## ACCESS

Parking spaces available  
Easy access to highways 13, 40  
Bus 70

# Ground floor

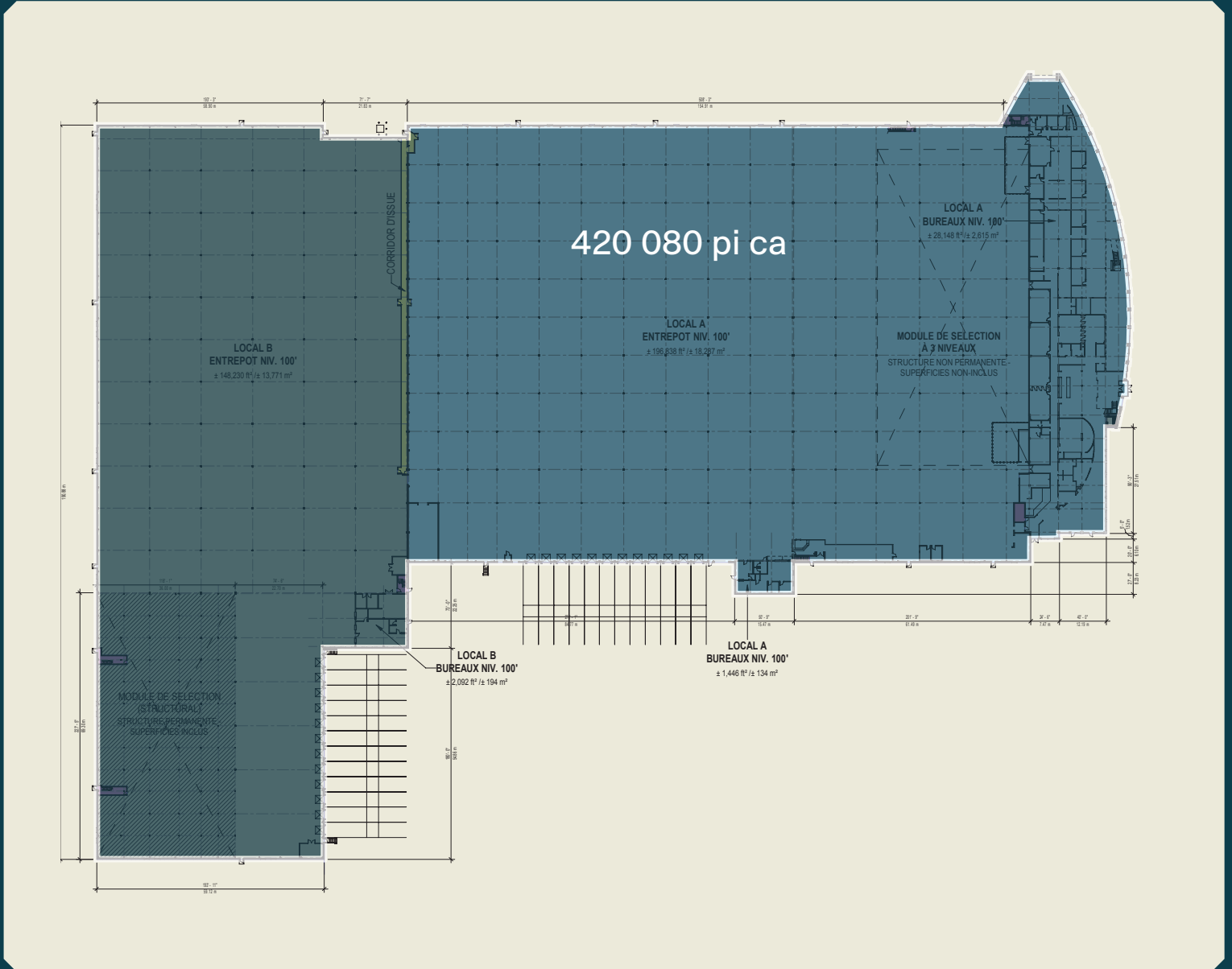



# Photos





# Photos





# Summary



## □ Certification aimed

## Relevant Information



### LEED

(Leadership in Energy and Environmental Design) is a rating system recognized in 150 countries and is designed to leave a legacy of high-quality, environmentally friendly buildings with a reduced impact on the environment.

- Available: Early 2024
- Year of construction: 2005
- Total available area: 420,080 sq. ft.
- Garage doors "Drive-in" : Total of one (1) door
- Loading dock doors : Total of twenty six (26) doors
- Clear Height - Warehouse: 30 ft.
- Electrical capacity of the building - 2,000 A
- Warehouse lighting - LED
- Trailer parking spaces - 35 spaces

# MONTONI

For any questions related to this  
presentation, please contact:  
[abouchard@groupemontoni.com](mailto:abouchard@groupemontoni.com)