

Lower Level Office Space for Lease



# 1427 Ogilvie Road

Ottawa, ON

Lower Level Office Space

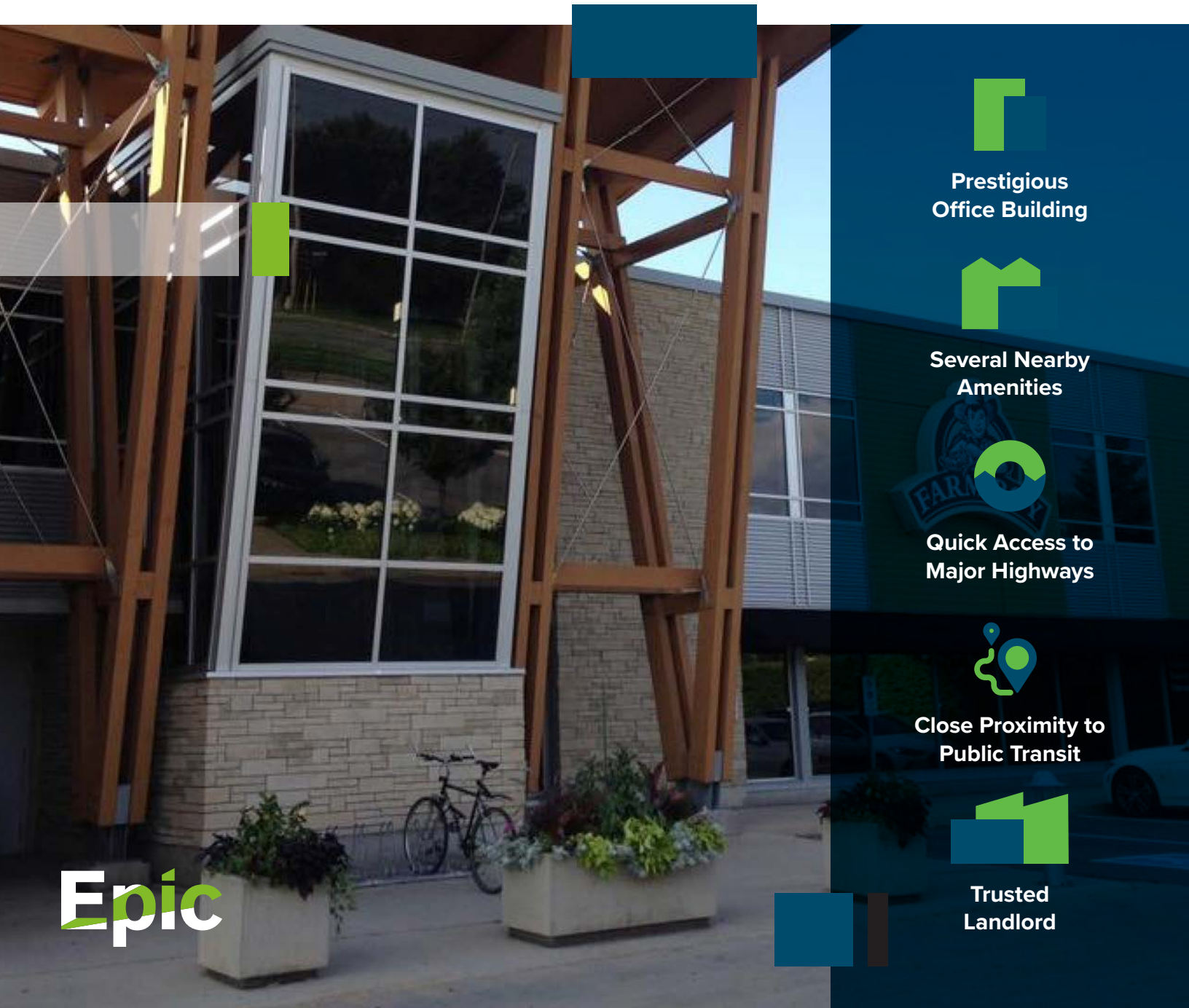

Prestigious  
Office Building



Several Nearby  
Amenities



Quick Access to  
Major Highways



Close Proximity to  
Public Transit



Trusted  
Landlord

**Epic**



# Lower Level Office Space

1427 Ogilvie is a 29,000 square foot 2 storey office building featuring a built-out lower level with office and storage. The building is located in a prominent location in Ottawa East, Gloucester.

The building offers ground level parking, prominent pylon signage opportunities and is head office for Farm Boy.

Numerous bus stops are located steps away, and the O-Train Blair Station is located 15 minutes away. The property is highly accessible via Highway 417 and Aviation Parkway.

Tenants can take advantage of several food and service retail amenities such as Gloucester Center to the east and St. Laurent Shopping Centre to the west.

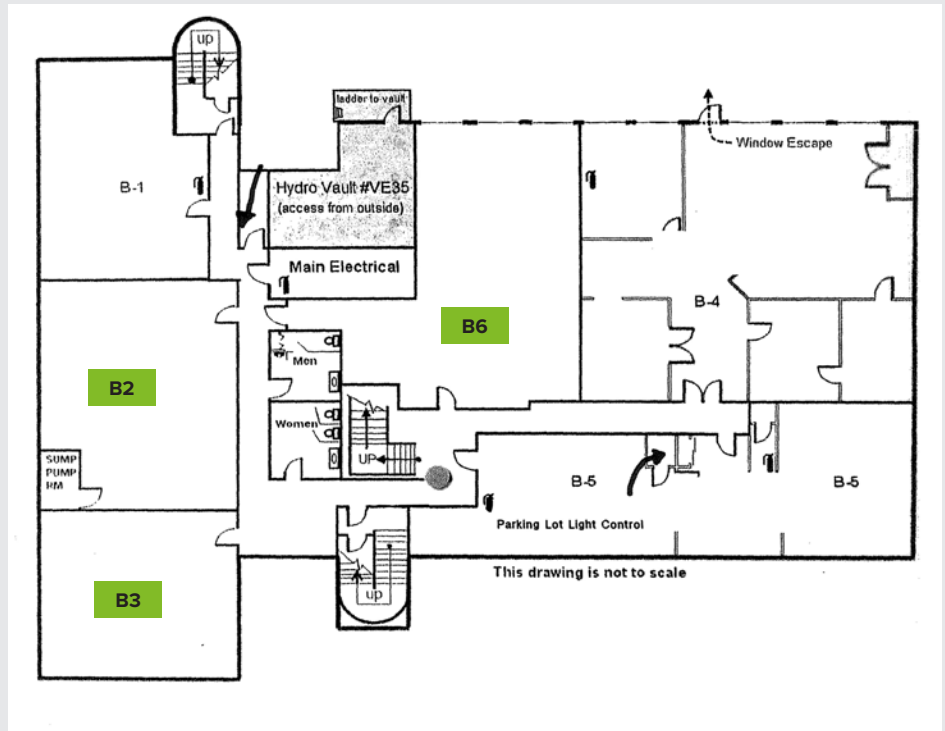

Suite	Size (SF)	Availability	Net Rent psf
B2	926	Immediate	\$20.00 Gross
B3	1,016	Immediate	\$20.00 Gross
B6	1,433	Immediate	\$20.00 Gross



- Convenient access to Highway 417
- Superior location in Ottawa East, Gloucester
- Minutes away from numerous amenities

For more information please contact:

**ABDULLAH SAAD\***  
613.282.2767  
asaad@epicis.com

\*Salesperson

Epic Investment Services  
111 Colonnade Road N, Suite 206  
Nepean, ON K2E 7M3

[epicinvestmentservices.com](http://epicinvestmentservices.com)

