



For Lease

Functional Industrial Units Available For Lease

11 Vulcan Street and 13-15 Vulcan Street, Etobicoke, ON

Accelerating success.

Asking:

\$19.00
Net PSF

Stewart Metcalfe*, SIOR

Executive Vice President
Industrial Facilities Group
+1 416 274 8987
stewart.metcalfe@colliers.com

Nick Stathers*, MBA (Hons., Fin.)

Associate Vice President
Industrial Facilities Group
+1 905 464 3736
nick.stathers@colliers.com

[View Online Listing](#)



11 Vulcan Street

Property Overview



Proximity Hwy's
409/401/427/400/27



E1 Zoning

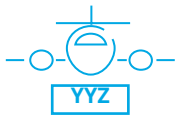

Lester B Pearson
International Airport

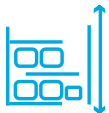

15'11" Clear Height



1 Truck Level Door

Functional industrial unit in high demand Pearson airport node. Possesses 15'11" clear height, 1 truck-level door, and a practical office / warehouse ratio.

Located in close proximity to public transit options, Hwy's 409/401/427/400/27, and a multitude of amenities.

Owned and managed by a professional landlord. Ample on site parking. Fully sprinklered.

| | |
|--------------------------|-------------------------------------|
| Address | 11 Vulcan Street, Etobicoke |
| Main Cross Street | Martin Grove Road and Vulcan Street |
| Zoning | E1 |
| Unit Area | 6,547 SF |
| Warehouse Area | 75% |
| Office Area | 25% |
| Ceiling Height | 15' 11" |
| Shipping | 1 truck level door |
| Sprinklers | Yes |
| Term: | 3 - 5 Years |
| Asking Lease Rate | \$19.00 Net per SF |
| TMI (2022) | \$4.45 per SF |
| Gross Rent | \$23.45 per SF |



Floor Plan

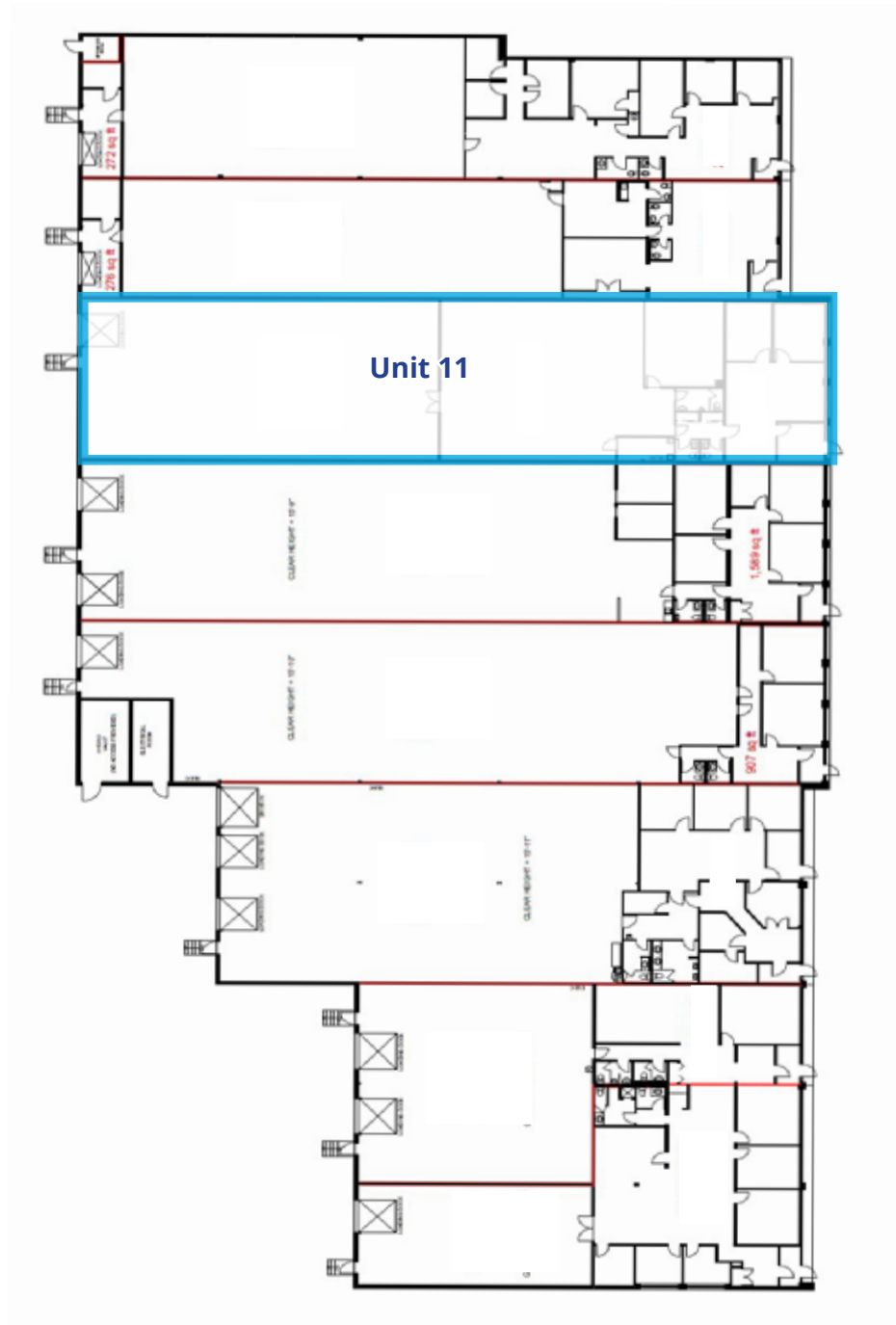

11 Vulcan St Highlights

- Well-maintained warehouse with a functional layout.
- 15'11" Clear height.
- 1 Truck level door
- Centrally located
- Ample public transit options and amenities available in the area.

6,547
Square Feet

11 Vulcan Street



13 - 15 Vulcan Street

Property Overview



Proximity Hwy's
409/401/427/400/27



E1 Zoning

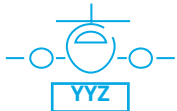

Lester B Pearson
International Airport

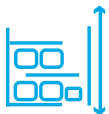

15'9"- 15'10"
Clear Height



3 Truck Level Doors

Functional industrial units in high demand Pearson airport node. Possesses 15' 9"- 15' 10" clear height, 3 truck-level doors, and a practical office / warehouse ratio.

Located in close proximity to public transit options, Hwy's 409/401/427/400/27, and a multitude of amenities.

Owned and managed by a professional landlord. Ample on site parking. Fully sprinklered.

| | |
|--------------------------|-------------------------------------|
| Address | 13 - 15 Vulcan Street, Etobicoke |
| Main Cross Street | Martin Grove Road and Vulcan Street |
| Zoning | E1 |
| Unit Area | 12,593 SF |
| Warehouse Area | 80% |
| Office Area | 20% |
| Ceiling Height | 15' 9"- 15' 10" |
| Shipping | 3 truck level doors |
| Sprinklers | Yes |
| Term: | 3 - 5 Years |
| Asking Lease Rate | \$19.00 Net per SF |
| TMI (2022) | \$4.45 per SF |
| Gross Rent | \$23.45 per SF |



Floor Plan

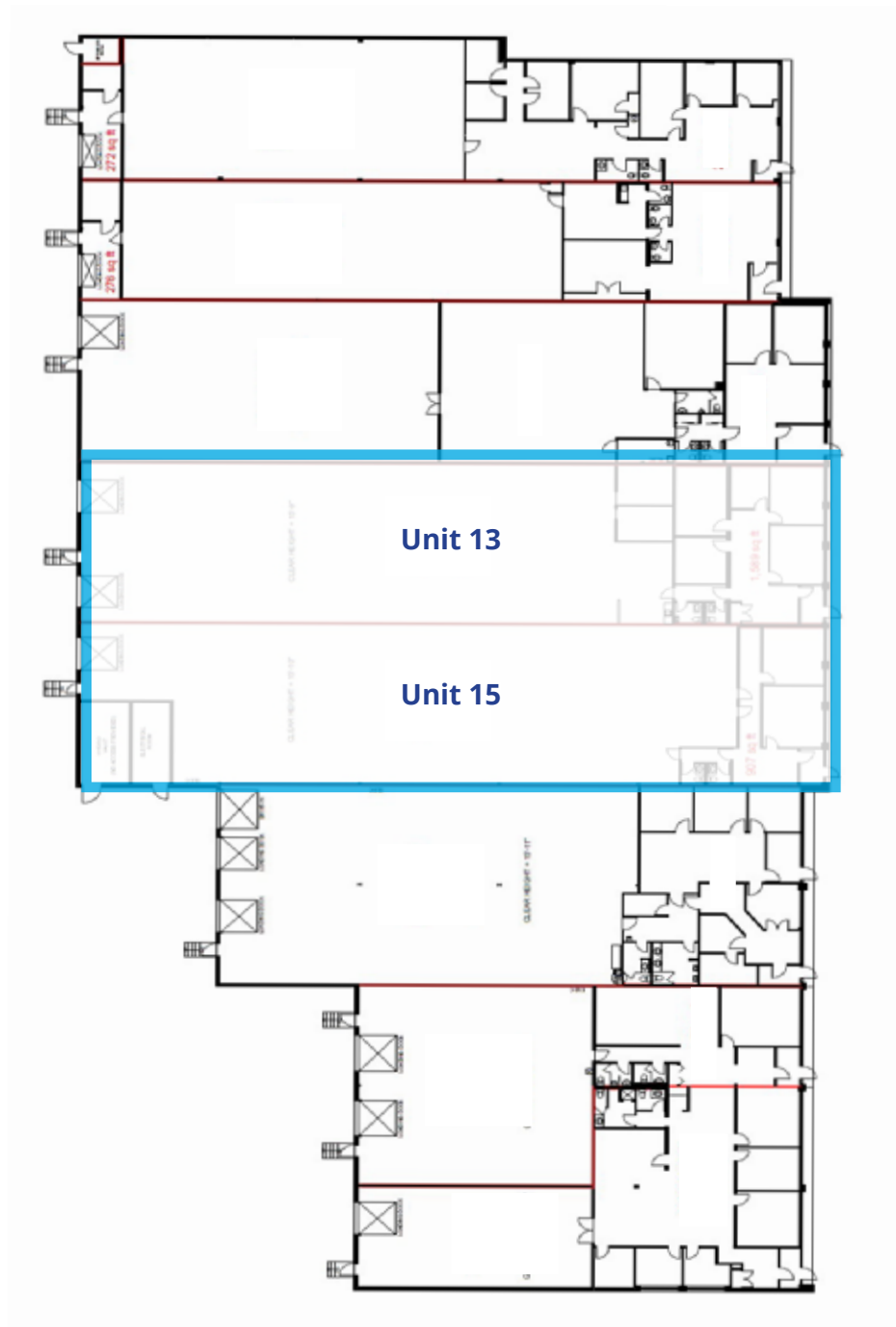

13 - 15 Vulcan St Highlights

- Well-maintained warehouse with a functional layout.
- 15' 9"- 15' 10" Clear height.
- 3 Truck level doors
- Centrally located
- Ample public transit options and amenities available in the area.

12,593
Square Feet

13 -15 Vulcan Street



Property Overview

11 Vulcan St & 13-15 Vulcan St



Proximity Hwy's
409/401/427/400/27



E1 Zoning

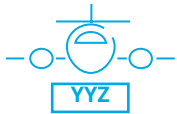

Lester B Pearson
International Airport

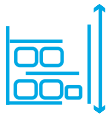

15' 9" - 15' 11" Clear
Height



4 Truck Level Doors

Functional industrial units in high demand Pearson airport node. Possesses 15' 9" - 15' 11" clear height, 4 truck-level doors, and a practical office / warehouse ratio.

Located in close proximity to public transit options, Hwy's 409/401/427/400/27, and a multitude of amenities.

Owned and managed by a professional landlord. Ample on site parking. Fully sprinklered.

| | |
|--------------------------|---|
| Address | 11 Vulcan Street & 13-15 Vulcan Street, Etobicoke |
| Main Cross Street | Martin Grove Road and Vulcan Street |
| Zoning | E1 |
| Unit Area | 19,140 SF |
| Warehouse Area | 80% |
| Office Area | 20% |
| Ceiling Height | 15' 9" - 15' 11" |
| Shipping | 4 truck level doors |
| Sprinklers | Yes |
| Term: | 3 - 5 Years |
| Asking Lease Rate | \$19.00 Net per SF |
| TMI (2022) | \$4.45 per SF |
| Gross Rent | \$23.45 per SF |



Floor Plan

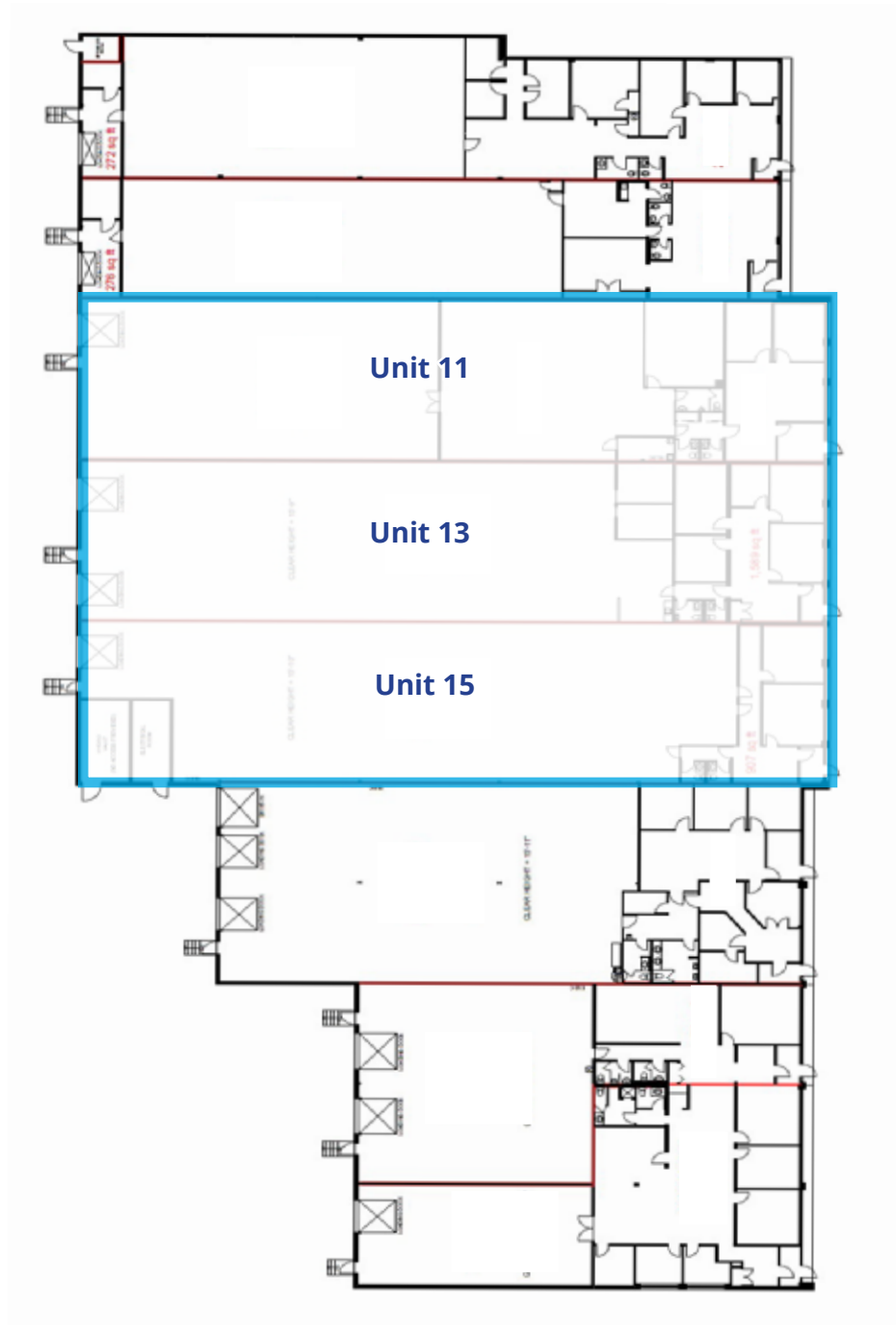

11 Vulcan St & 13 - 15 Vulcan St Highlights

- Well-maintained warehouse with a functional layout.
- 15' 9" - 15' 11" Clear height.
- 4 Truck level doors
- Centrally located
- Ample public transit options and amenities available in the area.

19,140
Square Feet

Nearby Amenities



11 & 13-15 Vulcan Street,
Toronto

- | | |
|---|--|
| 1 | Lester B Pearson International Airport - 3.5 km, 4 minutes drive |
| 2 | Costco - 18.3 km, 15 minutes drive |
| 3 | Loblaws - 8.4 km, 10 minutes drive |
| 4 | Etobicoke North Train Station 1.7 kms, 4 minutes drive |
| 5 | GO Transit - 11.8 km, 13 minutes drive |
| 6 | CIBC Bank - 1.1 kms, 4 minutes drive |
| 7 | RBC Bank - 1.1 kms, 4 minutes drive |
| 8 | Starbucks - 3.5 kms, 5 minutes drive |

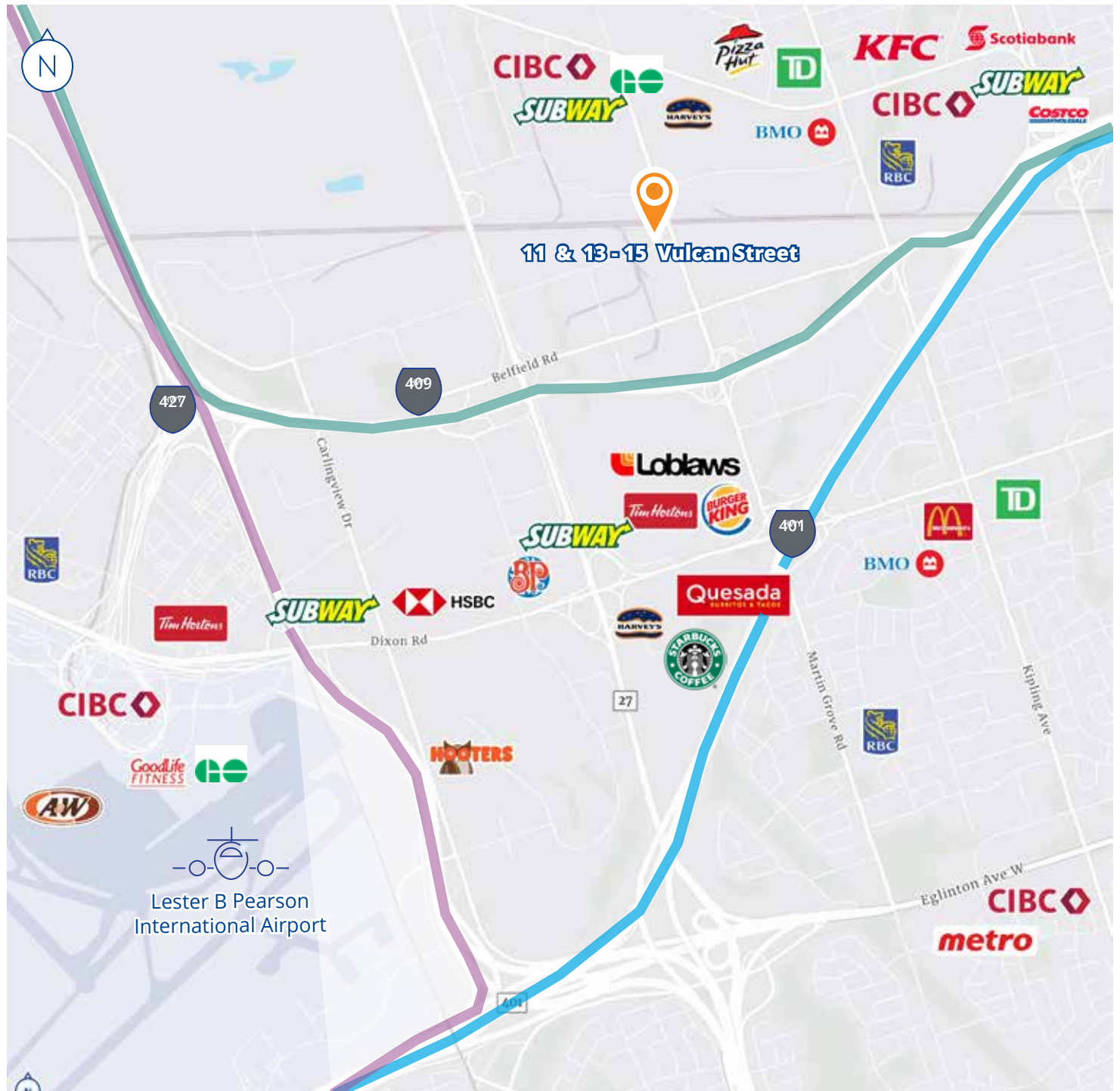



Colliers



11 & 13 - 15 Vulcan Street

Martin Grove Road

Vulcan Street

11 Vulcan Street and 13-15 Vulcan Street, Etobicoke, ON

Stewart Metcalfe*, SIOR

Executive Vice President
Industrial Facilities Group
+1 416 274 8987
stewart.metcalfe@colliers.com

Nick Stathers*, MBA (Hons., Fin.)

Associate Vice President
Industrial Facilities Group
+1 905 464 3736
nick.stathers@colliers.com

[View Online Listing](#)

Copyright © 2023 Colliers International. This document has been prepared by Colliers International for advertising and general information only. Colliers International makes no guarantees, representations or warranties of any kind, expressed or implied, regarding the information including, but not limited to, warranties of content, accuracy and reliability. Any interested party should undertake their own inquiries as to the accuracy of the information. Colliers International excludes unequivocally all inferred or implied terms, conditions and warranties arising out of this document and excludes all liability for loss and damages arising there from. This publication is the copyrighted property of Colliers International and/or its licensor(s). Copyright © 2023. Colliers Macaulay Nicolls Inc., Brokerage. *Sales Representative **Broker



collierscanada.com