

**AVISON  
YOUNG**

**8806/08/10 - 51 Ave**

**Edmonton, AB**

**Industrial Property for Lease**



**Get more  
information**

**David St. Cyr**  
Principal  
+1 780 964 4601  
david.stcyr@avisonyoung.com

**Bryce Williamson**  
Principal  
+1 587 984 6199  
bryce.williamson@avisonyoung.com

**Katherine Koebel**  
Client Services  
+1 587 315 0891  
katherine.koebel@avisonyoung.com

avisonyoung.com

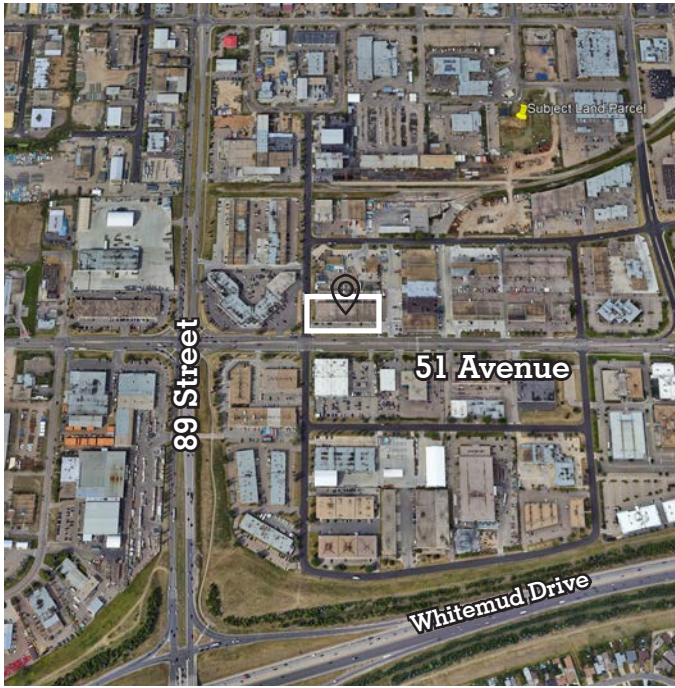

## Offering Summary

Municipal Address:	8806/08/10 - 51 Ave
Available:	Immediately
Zoning:	BE - Business Employment Zone
Area Available:	3,322 - 10,011 SF
Loading:	Grade (3 - 12' x 14')
Ceiling Height	20' Clear
Power:	100 amp, 120/208 volt, 3 phase (per bay)
Operating Costs:	\$5.14/SF (2024)
Lease Rate:	\$11.00/SF

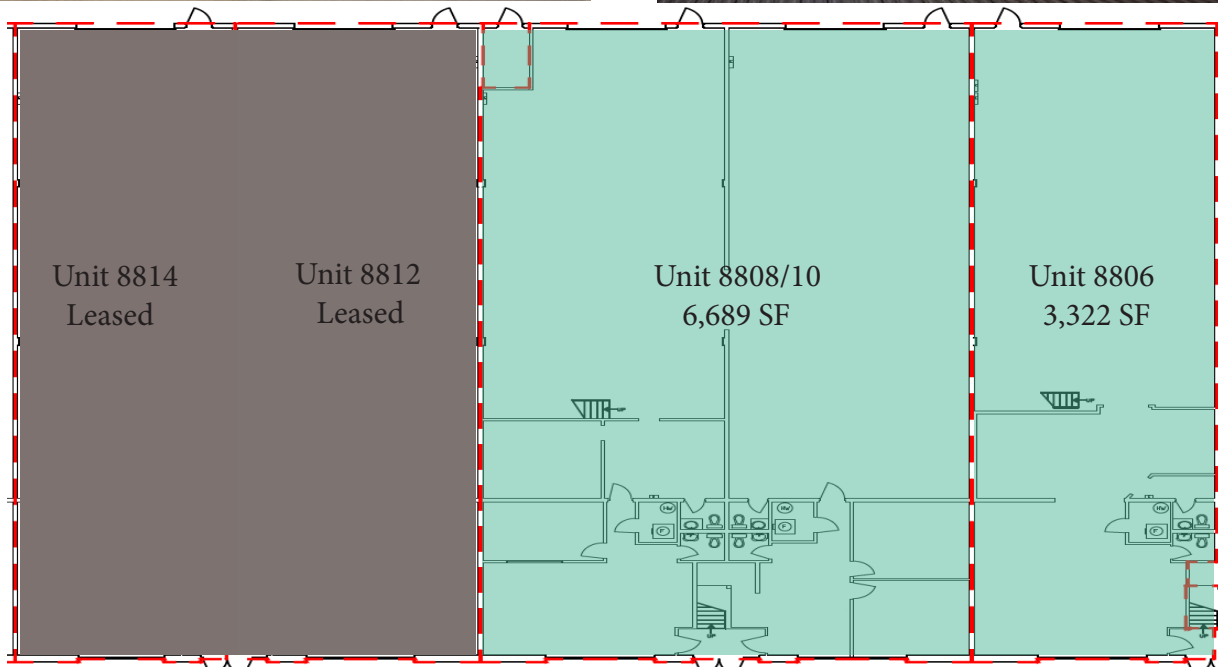

**Get more  
information**

**David St. Cyr**  
Principal  
+1 780 964 4601  
david.stcyr@avisonyoung.com

**Bryce Williamson**  
Principal  
+1 587 984 6199  
bryce.williamson@avisonyoung.com

**Katherine Koebel**  
Client Services Coordinator  
+1 587 315 0891  
katherine.koebel@avisonyoung.com

**AVISON  
YOUNG**