

FOR LEASE

CBRE

Douglasdale Business Centre

Calgary, Alberta

3442 118th Avenue SE



Property Information



Shell space with HVAC, ready for improvements



I-C zoned new generation industrial space



Access to Deerfoot Trail and Barlow Trail



Walking distance to Douglasglen BRT terminal



Walking distance to Douglas Square shopping centre



High Exposure to Deerfoot Trail

| | |
|-------------------------|-------------------------------|
| Year Built: | 2002 |
| Zoning: | I-C (Industrial – Commercial) |
| Operating Costs: | \$6.92 PSF |
| Net Rental Rate: | Market |
| Space Available: | Suite 124: 6,622 SF |
| Dock Loading: | 2 x (8'x10') Dock |
| Ceiling Height: | 27' Clear |
| Availability: | Immediately |
| Parking: | Free Surface |



Suite 124: 6,622 SF

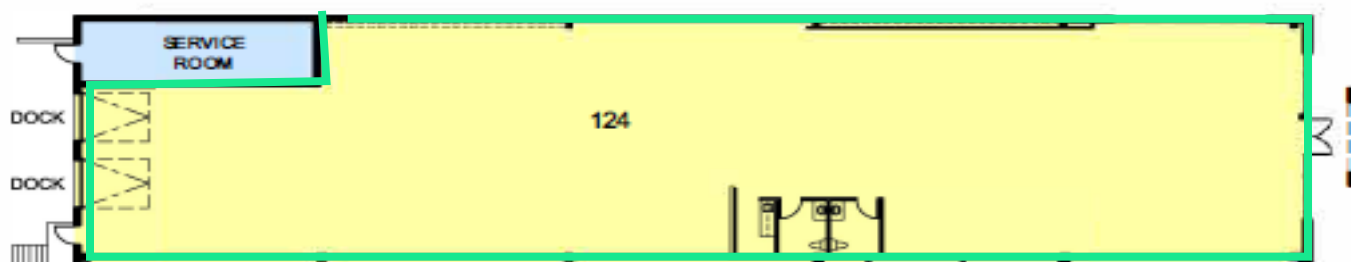

Location

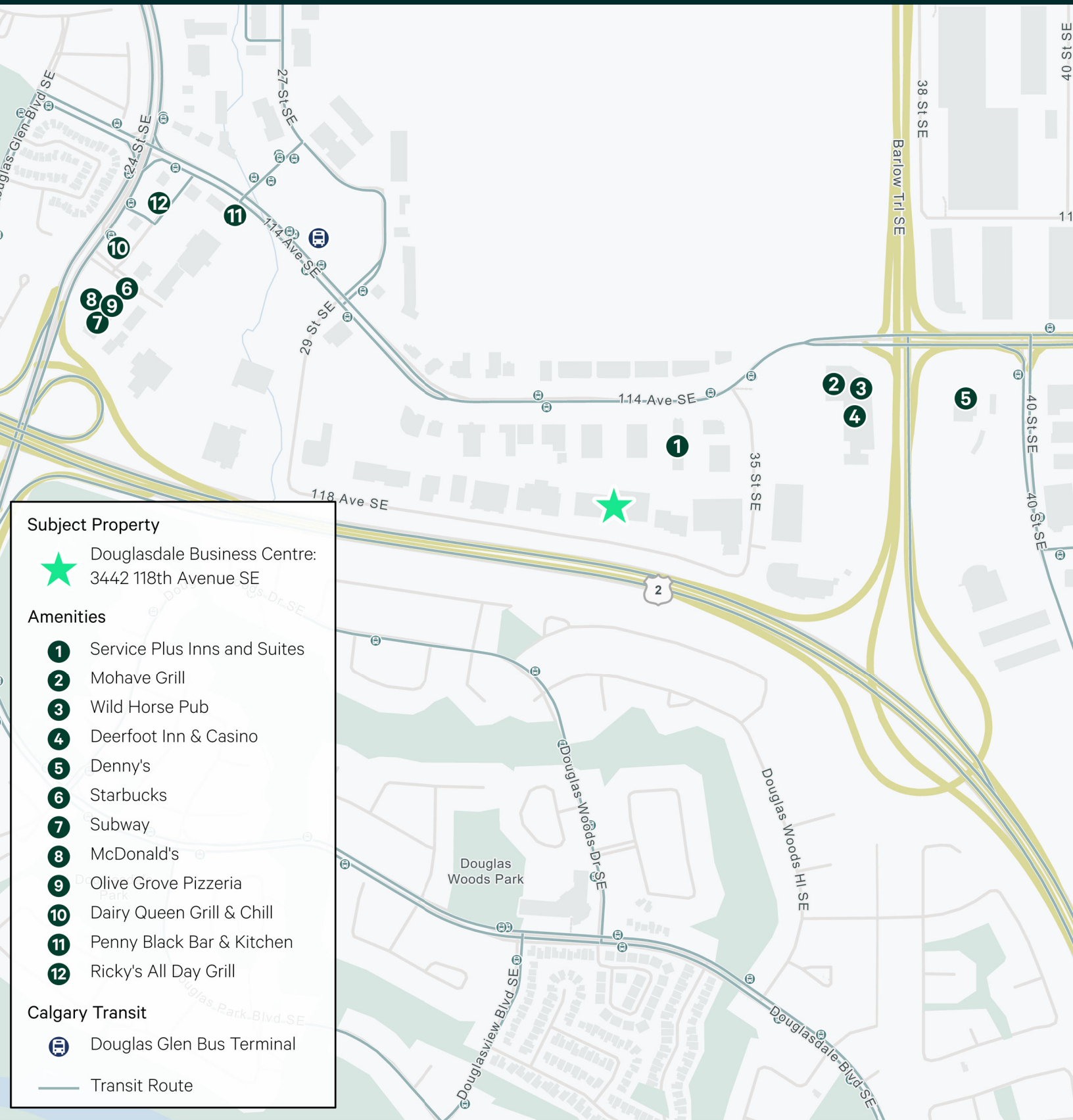

Subject Property



Douglasdale Business Centre:
3442 118th Avenue SE

Amenities

- 1 Service Plus Inns and Suites
- 2 Mohave Grill
- 3 Wild Horse Pub
- 4 Deerfoot Inn & Casino
- 5 Denny's
- 6 Starbucks
- 7 Subway
- 8 McDonald's
- 9 Olive Grove Pizzeria
- 10 Dairy Queen Grill & Chill
- 11 Penny Black Bar & Kitchen
- 12 Ricky's All Day Grill

Calgary Transit



Douglas Glen Bus Terminal

Transit Route



Douglasdale Business Centre

3442 118th Avenue SE

For more information, please contact:

Stuart Watson

Senior Vice President
T 403 750 0540
stuart.watson@cbre.com

Luke Hamill

Senior Vice President
T 403 294 5707
luke.hamill@cbre.com

Cameron Woods

Vice President
T 403 303 4562
cameron.woods@cbre.com

Sara Atchison

Associate
T 403 750 0526
sara.atchison@cbre.com

CBRE

This disclaimer shall apply to CBRE Limited, Real Estate Brokerage, and to all other divisions of the Corporation; to include all employees and independent contractors ("CBRE"). All references to CBRE Limited herein shall be deemed to include CBRE, Inc. The information set out herein, including, without limitation, any projections, images, opinions, assumptions and estimates obtained from third parties (the "Information") has not been verified by CBRE, and CBRE does not represent, warrant or guarantee the accuracy, correctness and completeness of the Information. CBRE does not accept or assume any responsibility or liability, direct or consequential, for the Information or the recipient's reliance upon the Information. The recipient of the Information should take such steps as the recipient may deem necessary to verify the Information prior to placing any reliance upon the Information. The Information may change and any property described in the Information may be withdrawn from the market at any time without notice or obligation to the recipient from CBRE. CBRE and the CBRE logo are the service marks of CBRE Limited and/or its affiliated or related companies in other countries. All other marks displayed on this document are the property of their respective owners. All Rights Reserved.