

1,568<sub>sf</sub> – 6,045<sub>sf</sub>



## BELTLINE OFFICE SPACE FOR LEASE

**Mount Royal West**  
906 16th Avenue SW, Calgary



**Allan Jones**, EXECUTIVE VICE PRESIDENT

c: 403-850-7621 • d: 403-294-7188 • [ajones@barclaystreet.com](mailto:ajones@barclaystreet.com)

**Murray Ion**, VICE PRESIDENT, PARTNER

c: 403-797-3103 • d: 403-294-7179 • [mion@barclaystreet.com](mailto:mion@barclaystreet.com)

**Anders O'Connor**, ASSISTANT (UNLICENSED)

c: 516-279-0198 • d: 587-393-9331 • [aoconnor@barclaystreet.com](mailto:aoconnor@barclaystreet.com)



**TCN**  
WORLDWIDE  
REAL ESTATE SERVICES

LOCAL  
EXPERTISE  
MATTERS

403-290-0178 • 200, 407 8 AVENUE SW, CALGARY, AB T2P 1E5 • [WWW.BARCLAYSTREET.COM](http://WWW.BARCLAYSTREET.COM)





Situated in an upscale neighbourhood known for its fine dining, casual cuisine, trendy cafes, boutique shopping, and international retailers.

The community has access to a range of services to cater to their lifestyle needs, such as Goodlife Fitness, Urban Fare, Canadian Tire and Shoppers Drug Mart.

## LEASE INFORMATION

**ADDRESS:** 906 16th Avenue SW, Calgary

**AVAILABLE FOR LEASE:**  
1,568 – 6,045 sq. ft. – Suite 300

- Base building condition.
- Balcony.

**AVAILABILITY:** Immediate

**T.I.A.:** Negotiable

**PARKING:**  
Ample parking is available in the underground parkade at market rate.

**OP. COSTS AND TAXES:**  
\$19.40 per sq. ft. (est.) plus utilities.

**LEASE RATE:** Market







DEMISING OPTIONS **1,568 – 6,045** SQ.FT.

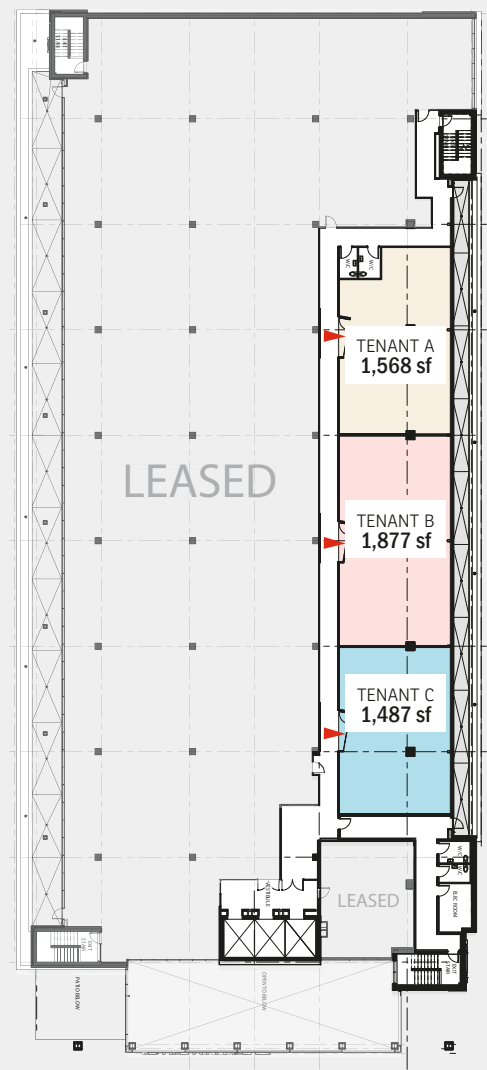
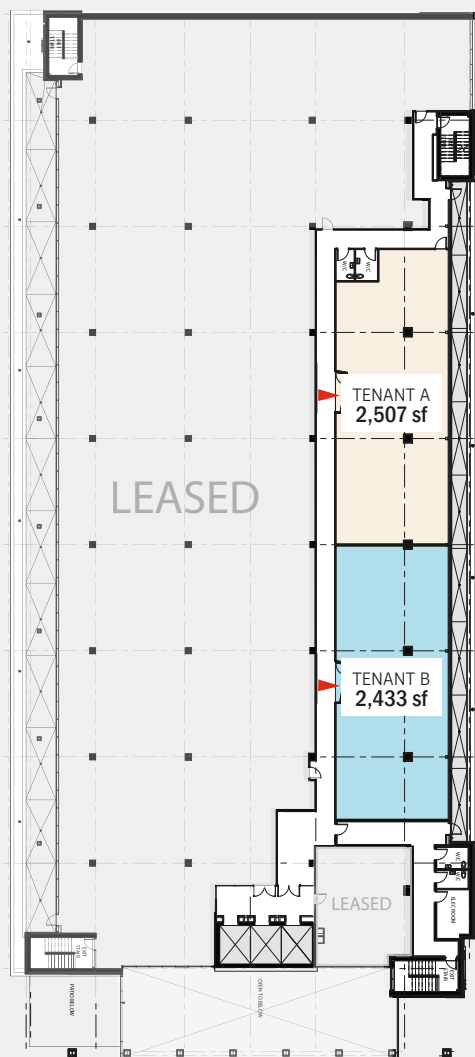
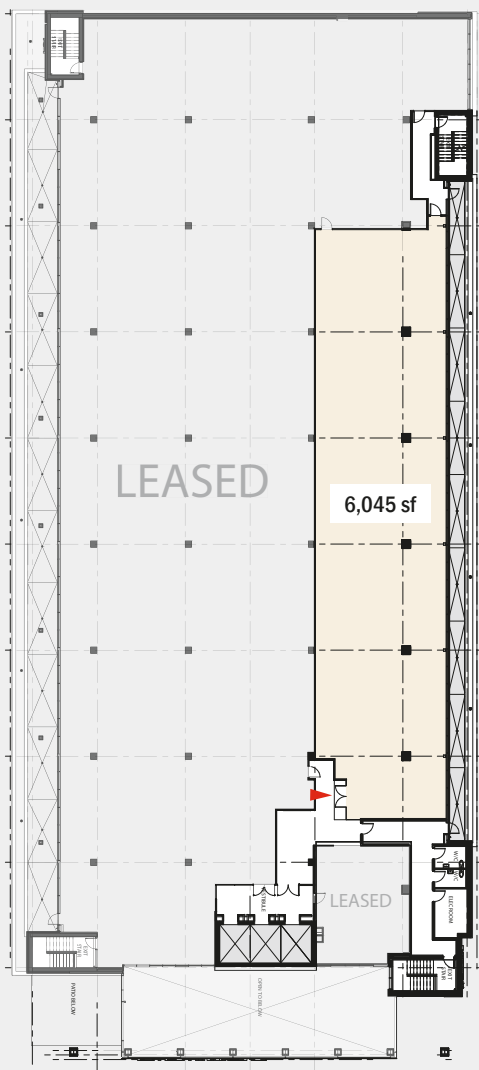





The information contained herein has been gathered from sources deemed reliable, but is not warranted as such and does not form any part of any future contract. This offering may be altered or withdrawn at any time without notice.

Copyright © 2025 Barclay Street Real Estate Ltd. All rights reserved.

