

**CBRE**

**Industrial Freestand | For Lease**



# **1851 Sandstone Manor**

Pickering, ON

**Available Immediately**

## Property Details

Location	Whites Road & Highway 401
Size	56,445 sq. ft.
Clear Height	18 ft.
Shipping	2 truck-level doors
Parking	181 parking stalls + Potential for additional 159 parking stalls available offsite
Possession	Immediate
Asking Rate	Speak with Listing Agents
TMI (2023)	\$3.55 per sq. ft.

## Highlights



Ample nearby amenities



Fiber to the Building



Possibility for additional parking on excess land



Immediate access to highway 401



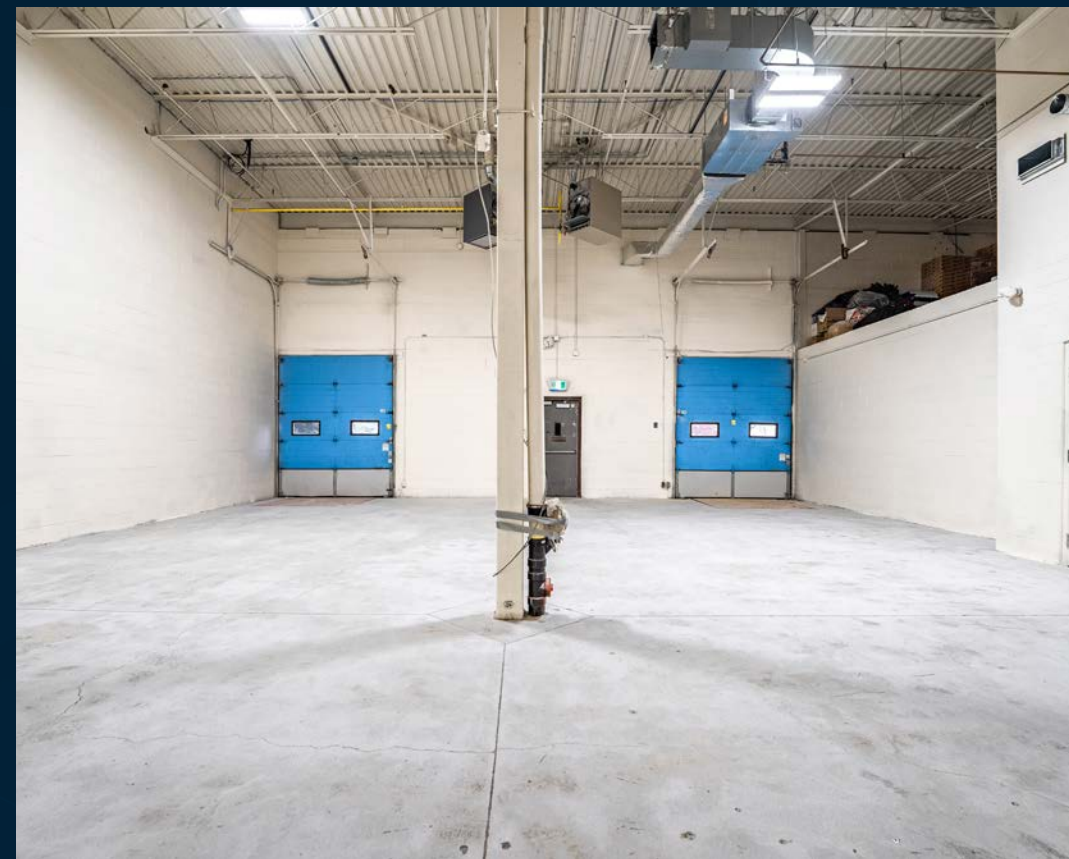
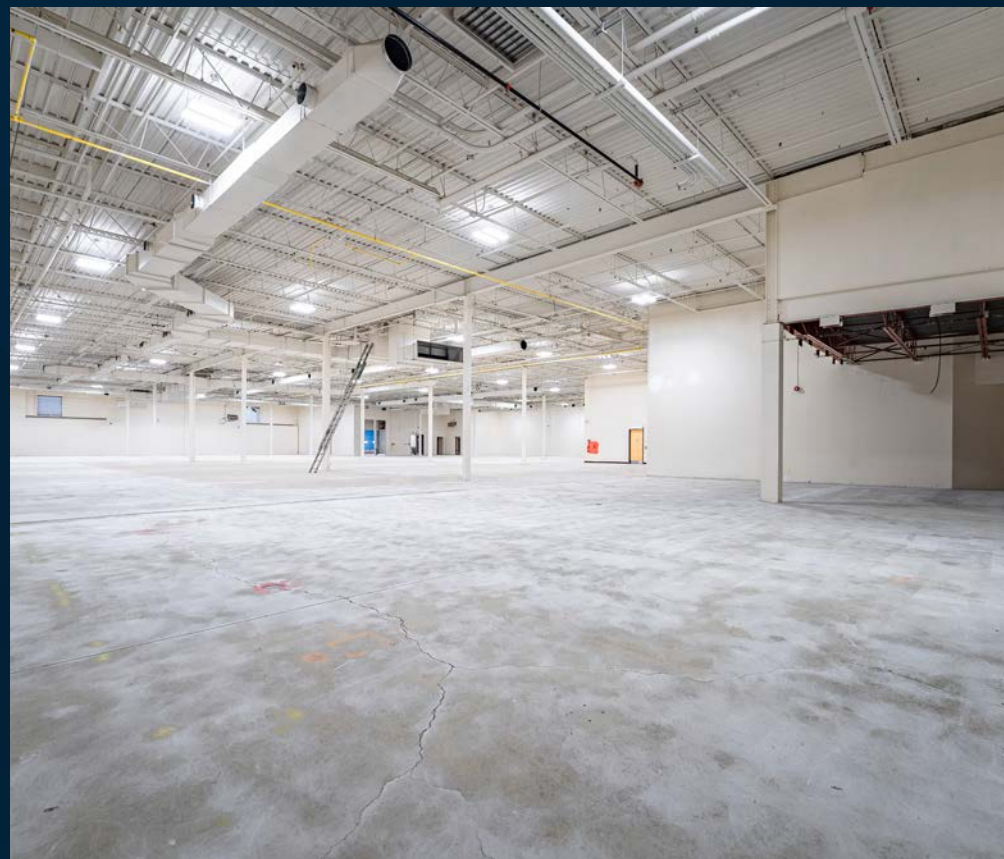

# Configuration 1

Industrial 26,318 sq. ft.

Office 30,127 sq. ft.  
First floor: 21,216 sq. ft.  
Second floor: 8,911 sq. ft.

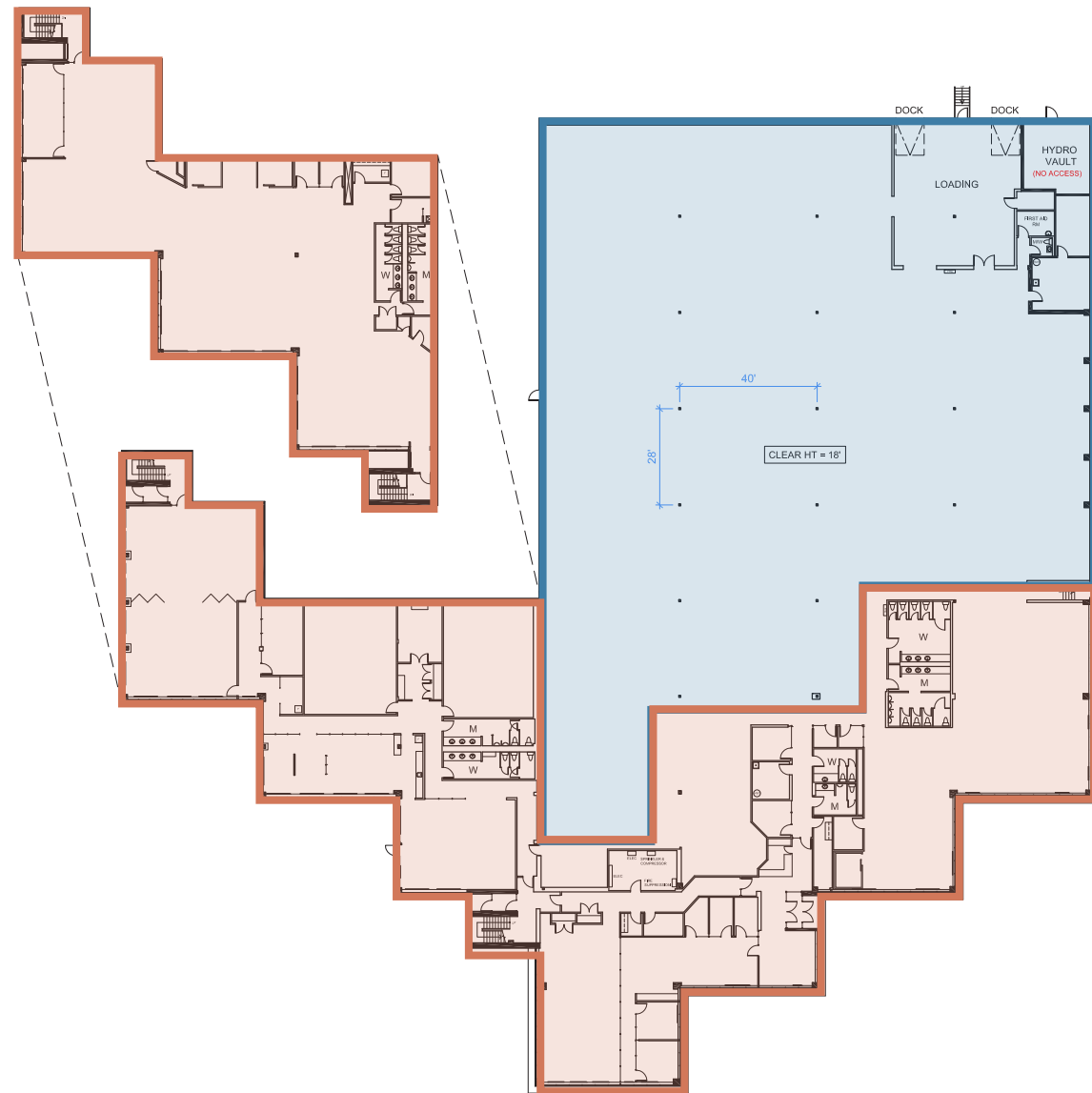

# Configuration 2

Industrial 47,534 sq. ft.

2nd Floor Office 8,911 sq. ft.

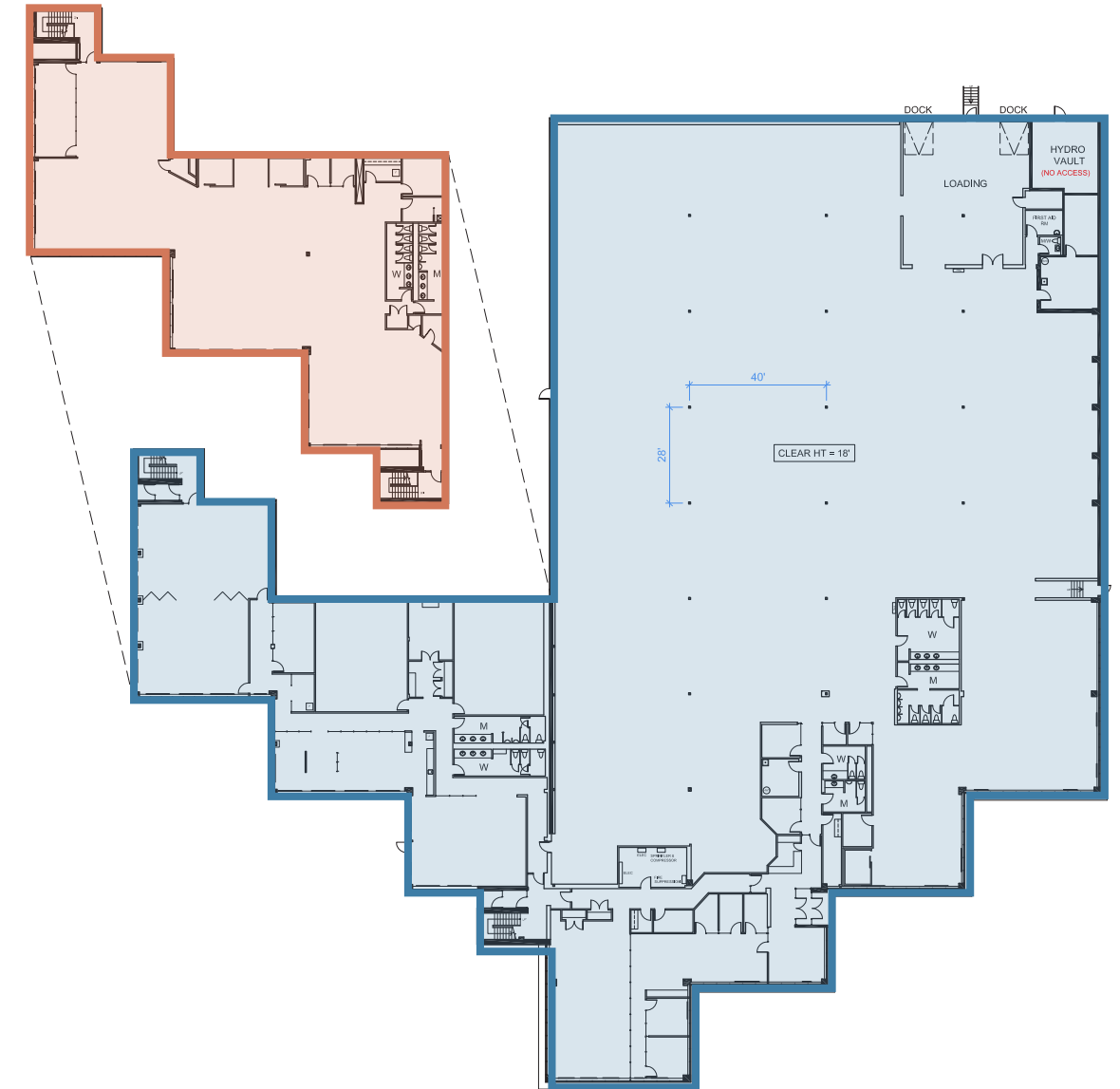

## Legend

- Industrial ■
- Office ■

1851 Sandstone Manor  
Pickering | ON

## Demographics



POPULATION

**390,574**



LABOUR FORCE

**65%**



MEDIAN AGE

**40**

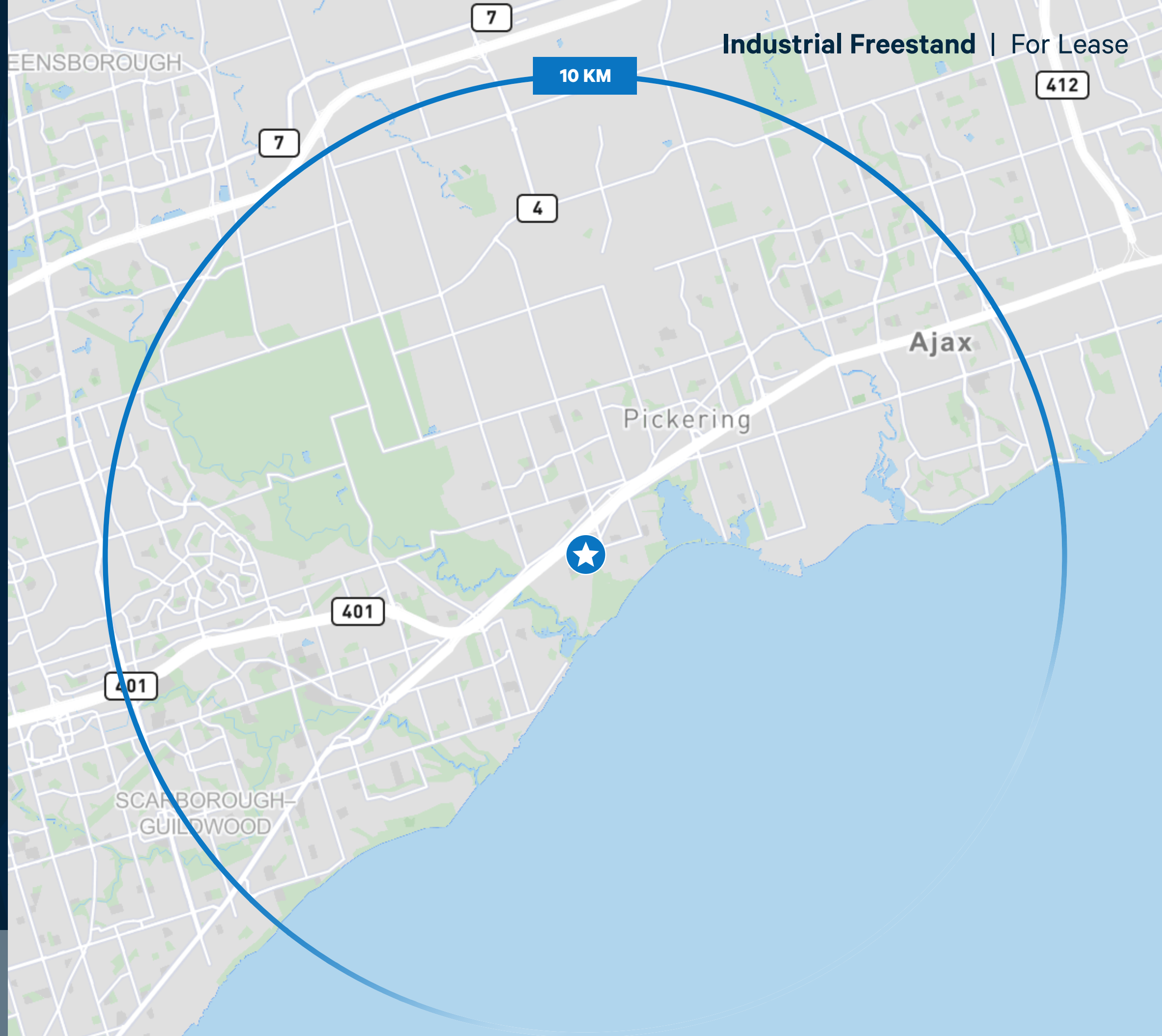

# Amenities

## ★ Subject Property

## 🍴 Restaurants

1. Wing House Express Pickering
2. Gino's Famous Pizza
3. Lone Star Texas Grill
4. Wimpy's Diner
5. Belaggios Gelato
6. Milanu's Tandoori Grill
7. Bollocks Pub & Kitchen
8. Tim Hortons
9. Second Cup
10. IceTales
11. The Fox Goes Free
12. Knights Corner Bar & Lounge

## 🛒 Retail

1. Sport Chek Outlet
2. Shoppers Drug Mart
3. FreshCo
4. The Home Depot
5. Food Basics
6. Michaels
7. Metro
8. LCBO

## 💰 Banks

1. RBC Royal Bank
2. Scotiabank
3. CIBC
4. BMO
5. TD Canada Trust

## 🛢️ Gas Stations

1. Petro-Canada & Car Wash
2. Shell
3. Esso
4. GLOBAL

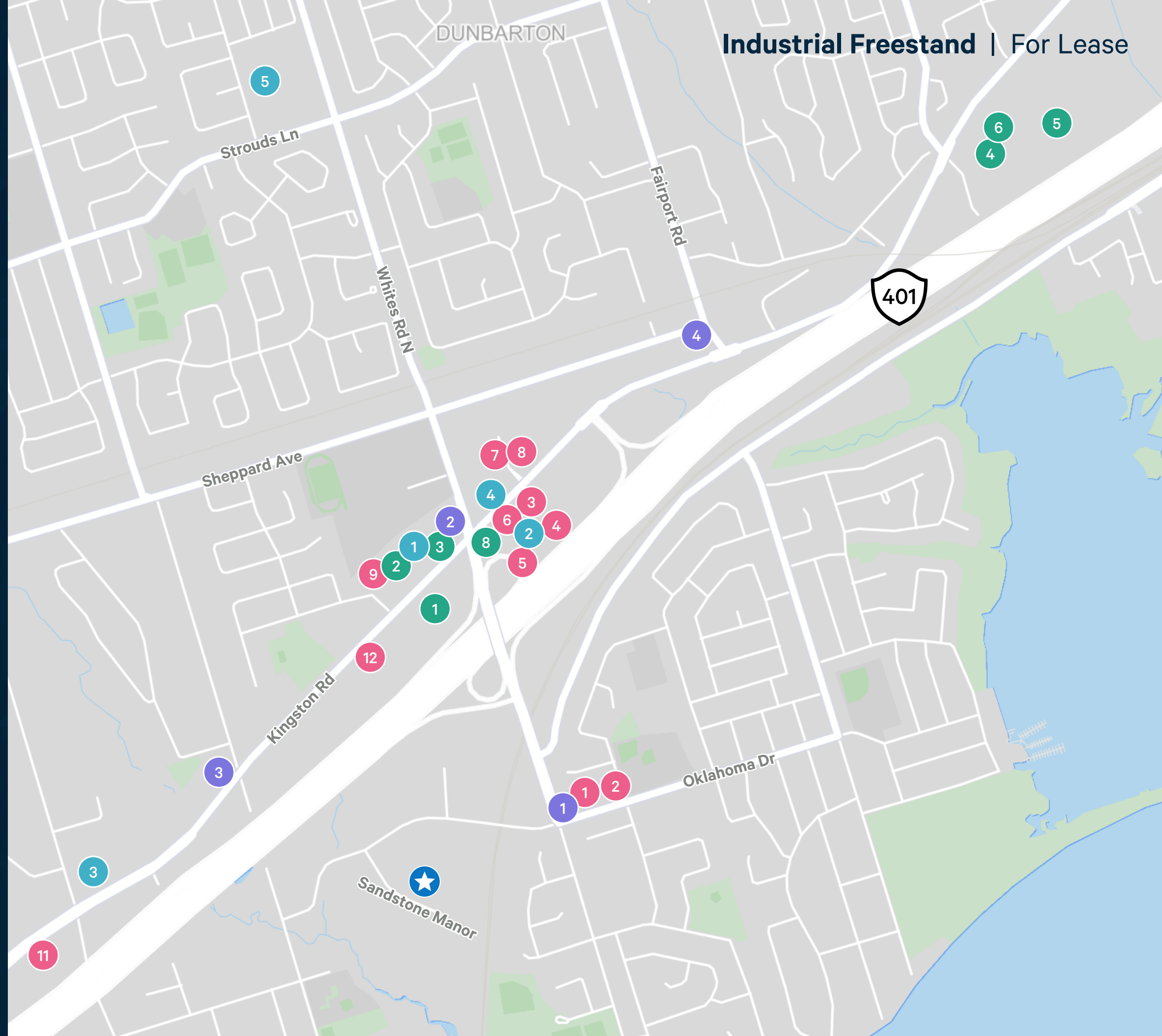

# Zoning & Permitted Uses

## Zoning is M1-1

Permitted uses for this zone includes the following:

- business offices;
- food preparation plants;
- light manufacturing plants;
- public uses;
- scientific or medical laboratories;
- warehouses.
- one accessory dwelling unit.



1851 Sandstone Manor  
Pickering | ON

# Industrial Freestand | For Lease



Potential Additional  
Parking Stalls Offsite

## Contact Us

**Graeme McDonald\***  
Executive Vice President  
+1 416 495 6270  
graeme.mcdonald@cbre.com

**Tony Gill\***  
Senior Vice President  
+1 416 495 6261  
tony.gill@cbre.com

\*Sales Representative | All Outlines Are Approximate | CBRE Limited, Brokerage | 2005 Sheppard Ave. E., #800, Toronto, ON M2J 5B4

This disclaimer shall apply to CBRE Limited, Real Estate Brokerage, and to all other divisions of the Corporation; to include all employees and independent contractors ("CBRE"). The information set out herein, including, without limitation, any projections, images, opinions, assumptions and estimates obtained from third parties (the "Information") has not been verified by CBRE, and CBRE does not represent, warrant or guarantee the accuracy, correctness and completeness of the Information. CBRE does not accept or assume any responsibility or liability, direct or consequential, for the Information or the recipient's reliance upon the Information. The recipient of the Information should take such steps as the recipient may deem necessary to verify the Information prior to placing any reliance upon the Information. The Information may change and any property described in the Information may be withdrawn from the market at any time without notice or obligation to the recipient from CBRE. CBRE and the CBRE logo are the service marks of CBRE Limited and/or its affiliated or related companies in other countries. All other marks displayed on this document are the property of their respective owners. All Rights Reserved. Mapping Sources: Canadian Mapping Services canadamapping@cbre.com; MapPoint, DMTI Spatial, Envirionics Analytics, Microsoft Bing, Google Earth-