

# FOR LEASE



**1600 INDUSTRIAL ROAD**  
UNIT A2,  
CAMBRIDGE, ON

**2,579 SF**  
**Industrial Unit**



# The Opportunity

1600 Industrial Rd, Unit A2, Cambridge



2,579 SF industrial unit available for lease in Cambridge. Unit features include 851 SF office space, 13' clear ceiling height, 1 drive-in door and 400 amp/600 volt electrical service. 851 SF usable mezzanine area not included in total SF. Available for March 1, 2024 occupancy. Unit includes 3 parking spaces adjacent to the unit and 55 unassigned common spaces. Minutes from Highways 401 and 24. Many amenities nearby.



**Total Available Area**  
2,579 SF



**Loading**  
1 - 10' x 10'  
Drive-In Door



**Ceiling Height**  
13'



**Industrial Area**  
1,728 SF



**Zoning**  
M2 S.4.1.75.2



**Power**  
400 amps/  
600 volts



**Office Area**  
851 SF



**Lease Rate**  
\$14.25/SF



**TMI**  
\$4.50/SF

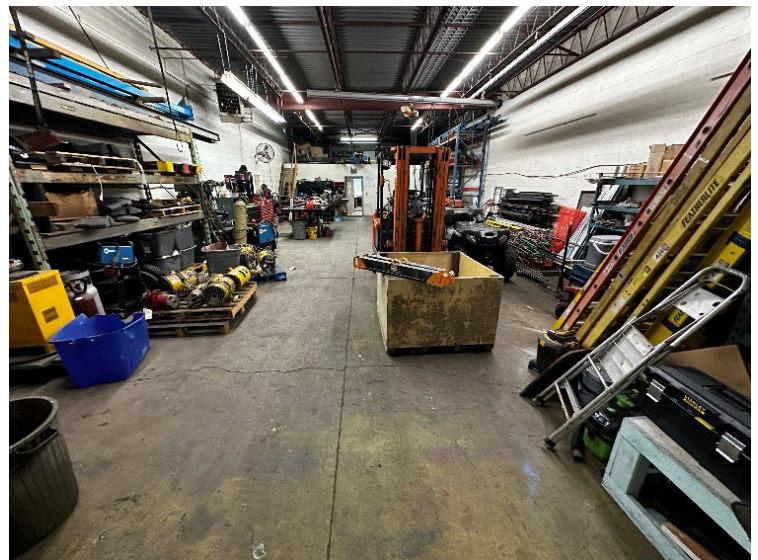
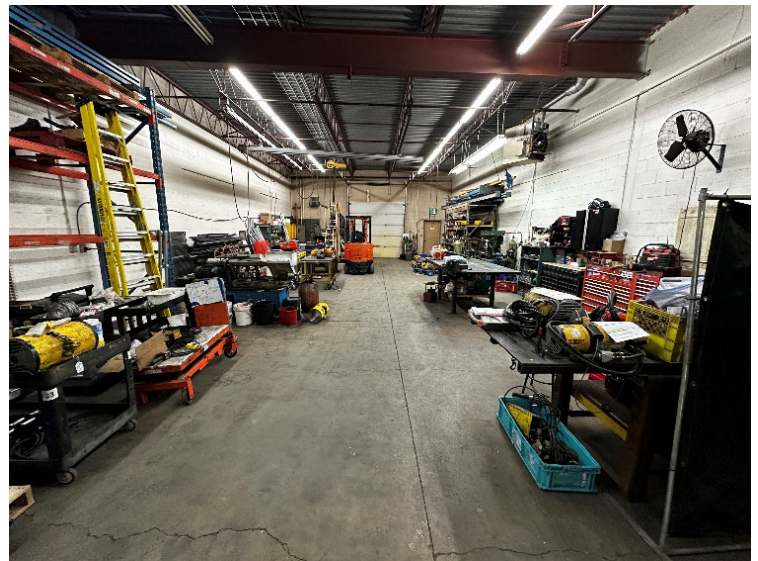



# Property Specifications

1600 Industrial Rd, Unit A2, Cambridge



<b>Total Available Area:</b>	2,579 SF
<b>Warehouse:</b>	1,728 SF
<b>Office:</b>	851 SF
<b>Additional SF: (Mezzanine)</b>	851 SF
<b>Ceiling Height:</b>	13'
<b>Loading Door:</b>	1 - 10' x 10' DI
<b>Power:</b>	400 amps/600 volts
<b>Zoning:</b>	M2 S.4.1.75.2
<b>TMI:</b>	\$4.50/SF
<b>Possession:</b>	March 1, 2024



**Lease Rate: \$14.25/SF**

## Site Plan

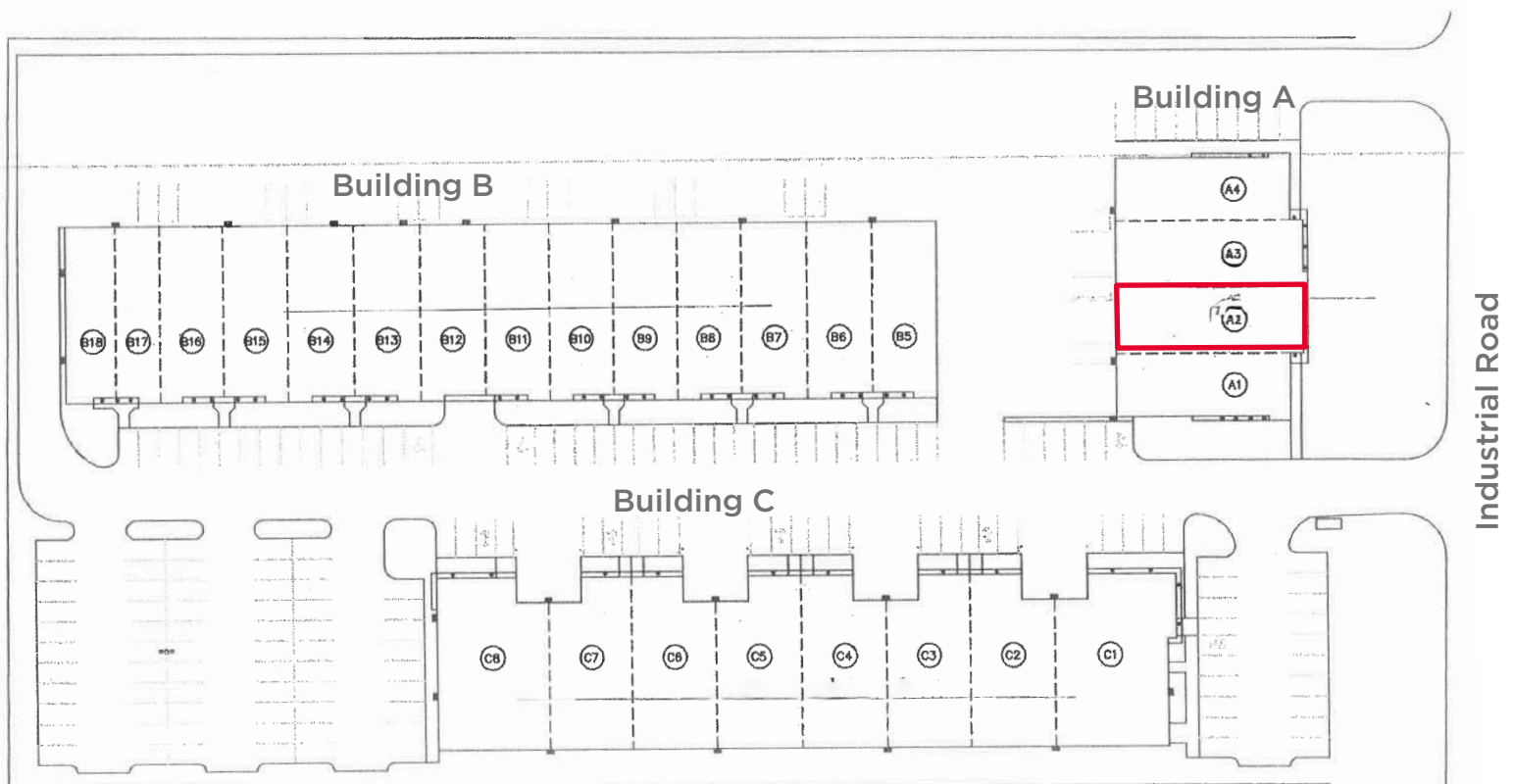



# LOCATION OVERVIEW

1600 Industrial Rd, Unit A2, Cambridge

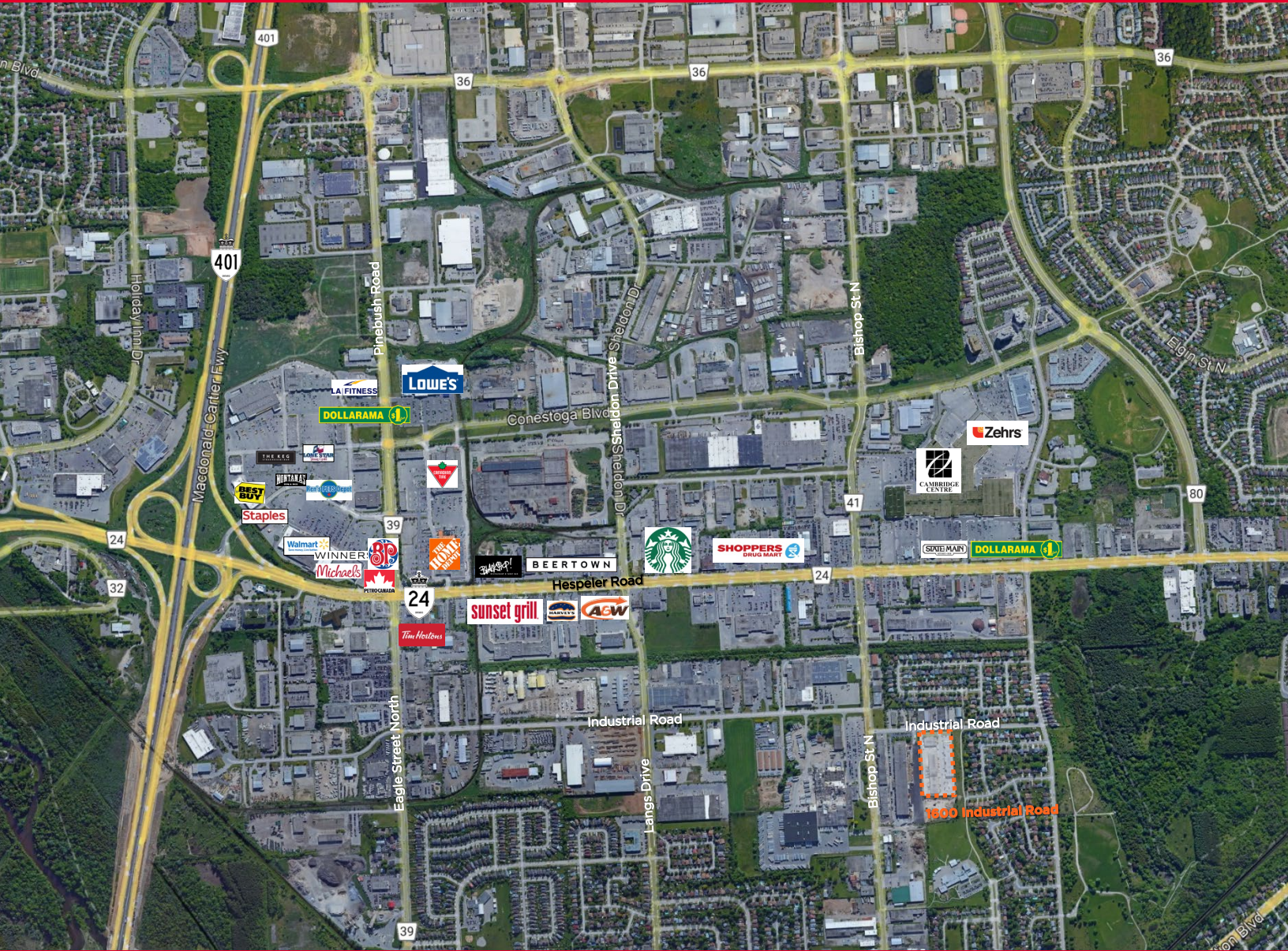

## Scott Anderson, SIOR\*\*

SENIOR VICE PRESIDENT  
519.804.4381  
scott.anderson@cushwakewr.com

## Joshua Buffinga\*

SALES REPRESENTATIVE  
519.804.4386  
joshua.buffinga@cushwakewr.com



## Jordan Palmer\*

SENIOR VICE PRESIDENT  
519.804.4384  
jordan.palmer@cushwakewr.com

## David Anderson\*\*

SENIOR VICE PRESIDENT  
519.804.4382  
david.anderson@cushwakewr.com

4295 King Street East Suite 401  
Kitchener, ON N2P 0C6  
519.585.2200  
www.cushwakewr.com

\*SALES REPRESENTATIVE \*\*BROKER

Cushman & Wakefield Waterloo Region Ltd. copyright 2024. No warranty or representation, express or implied, is made to the accuracy or completeness of the information contained herein, and same is submitted subject to errors, omissions, change of price, rental or other conditions, withdrawal without notice, and to any special listing conditions imposed by the property owner(s). As applicable, we make no representation as to the condition of the property (or properties) in question.