



#201 - 1024 Ridgeway Avenue
Coquitlam, BC

Austin Heights Centre

With excellent exposure from Nelson Street & Austin Avenue, the subject property offers a professional tenant mix including general/medical office users, retail/food groups, and national anchor Tenant BMO.

Jesse Godin

Senior Associate
Commercial Sales & Leasing
604 691 6636
jgodin@naicommercial.ca

NAI Commercial

1075 W Georgia St, Suite 1300
Vancouver, BC V6E 3C9
+1 604 683 7535
naicommercial.ca



#201 - 1024 Ridgeway Ave Coquitlam, BC

Location

Located in the heart of the Austin Avenue corridor in Coquitlam, this mixed-use professional building is within steps of transit and numerous amenities. Generous and convenient parking options with an abundance of well-planned natural light make this property a must look for any professional user.

Building Description

Austin Heights Centre was solidly built in 1980 with numerous improvements including a new roof in 2016, updated common areas, plumbing upgrades and more. The building has an excellent tenant mix anchored by BMO with secured and convenient parking off of Austin Avenue. A proactive and experienced property management only add to the long list of attributes for the property.

Floor Plan

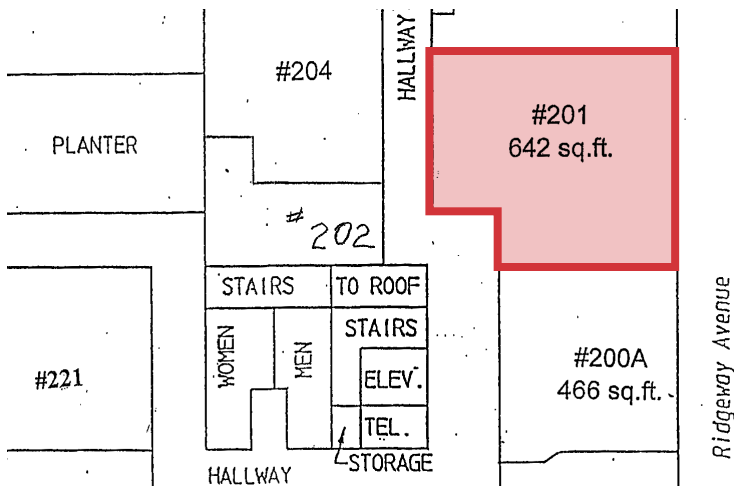

*Floor plan not as-built



Property Details

Unit Size

642 SF

Availability

July 1st, 2025

Lease Rate

\$22.00/SF

Additional Rent

\$20.97/SF (2024 estimate)

Zoning

C-2

Parking

Currently \$25.00 per random stall per month (subject to change)

Highlights

- ▶ Amenities within steps
- ▶ Near transit
- ▶ Elevator access
- ▶ Natural light

Jesse Godin
Senior Associate
Commercial Sales & Leasing
604 691 6636
jgodin@naicommercial.ca



No warranty or representation, express or implied, is made as to the accuracy of the information contained herein, and the same is submitted subject to errors, omissions, change of price, rental or other conditions, prior sale, lease or financing, or withdrawal without notice, and of any special listing conditions imposed by our principals no warranties or representations are made as to the condition of the property or any hazards contained therein are any to be implied.

NAI Commercial
1075 W Georgia St, Suite 1300
Vancouver, BC V6E 3C9
+1 604 683 7535
naicommercial.ca