

**7031 WESTMINSTER HWY.
RICHMOND PROFESSIONAL**

FOR LEASE

7031 WESTMINSTER HWY.
RICHMOND, B.C. V6X 1A3



PROSPERO
INTERNATIONAL REALTY INC.

Jeff Nightingale | Leasing Agent
jnightingale@prospero.ca
604-699-3483

Richmond Professional Features

7031 WESTMINSTER HWY.
RICHMOND, B.C.
V6X 1A3



Located in the City Centre of Richmond.

Richmond Professional is situated on the corner of Gilbert Road and Westminster Highway. This convenient location is directly across from Richmond General Hospital and is further enhanced by the nearby presence of CF Richmond Centre and Minoru Park.

All units are accessible by wheelchair, with an elevator servicing all floors. Units have air conditioning provided and in-suite janitor service is available. On-site parking for guests and reserved parking for tenants is available.

Units:

33 medical offices, professionals and retail shop.

Parking:

99 surface stalls

Offices – Base Rent:

Starting at \$19.00/sf

Offices – Additional Rent:

Estimated at \$19.19/sf

Jeff Nightingale | Leasing Agent | Prospero

jnightingale@prospero.ca

604-699-3483

Current Availability

7031 WESTMINSTER HWY.
RICHMOND, B.C.
V6X 1A3

Unit #	Area	Base Rent	Additional Rent	Available
203	1,017 sf	\$19.00/sf	\$19.19/sf Estimated for 2023	April 1, 2023
218	1,230 sf	\$19.00/sf	\$19.19/sf Estimated for 2023	Immediately

Lease rates subject to applicable tax.

SECOND FLOOR

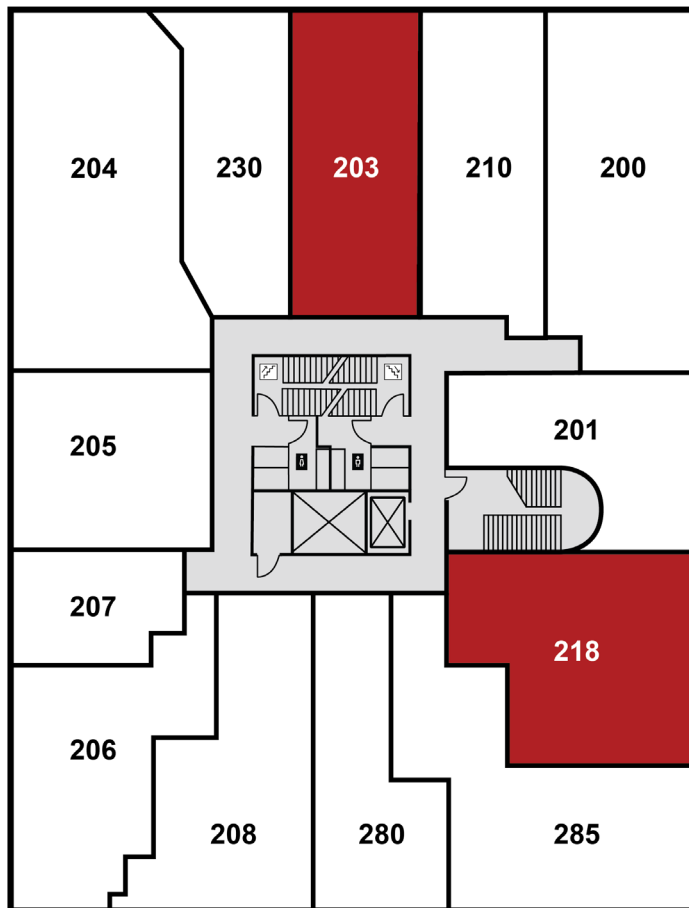

Unit #	Area	Base Rent	Additional Rent
309	880 sf	\$19.00/sf	\$19.19/sf Estimated for 2022
3 offices with reception area. Available immediately.			

Lease rates subject to applicable tax.

THIRD FLOOR

