

# CLASS 'A' OFFICE

BOMA BEST® Certified Gold Prestige Main Floor Office Space

1355 Taylor Avenue, Winnipeg, Manitoba



- **Excellent location** in Southwest Winnipeg
- **Great exposure** at busy northeast corner in South River Heights.
- Close proximity to Downtown and all major traffic routes.
- **Surrounded by numerous amenities** including retail, dining and recreational facilities.
- Completely clad in Manitoba limestone
- **Excellent access** from Kenaston Boulevard, Pembina Highway and Waverley Street.

# MAIN FLOOR CLASS 'A' OFFICE

1355 Taylor Avenue, Winnipeg, Manitoba

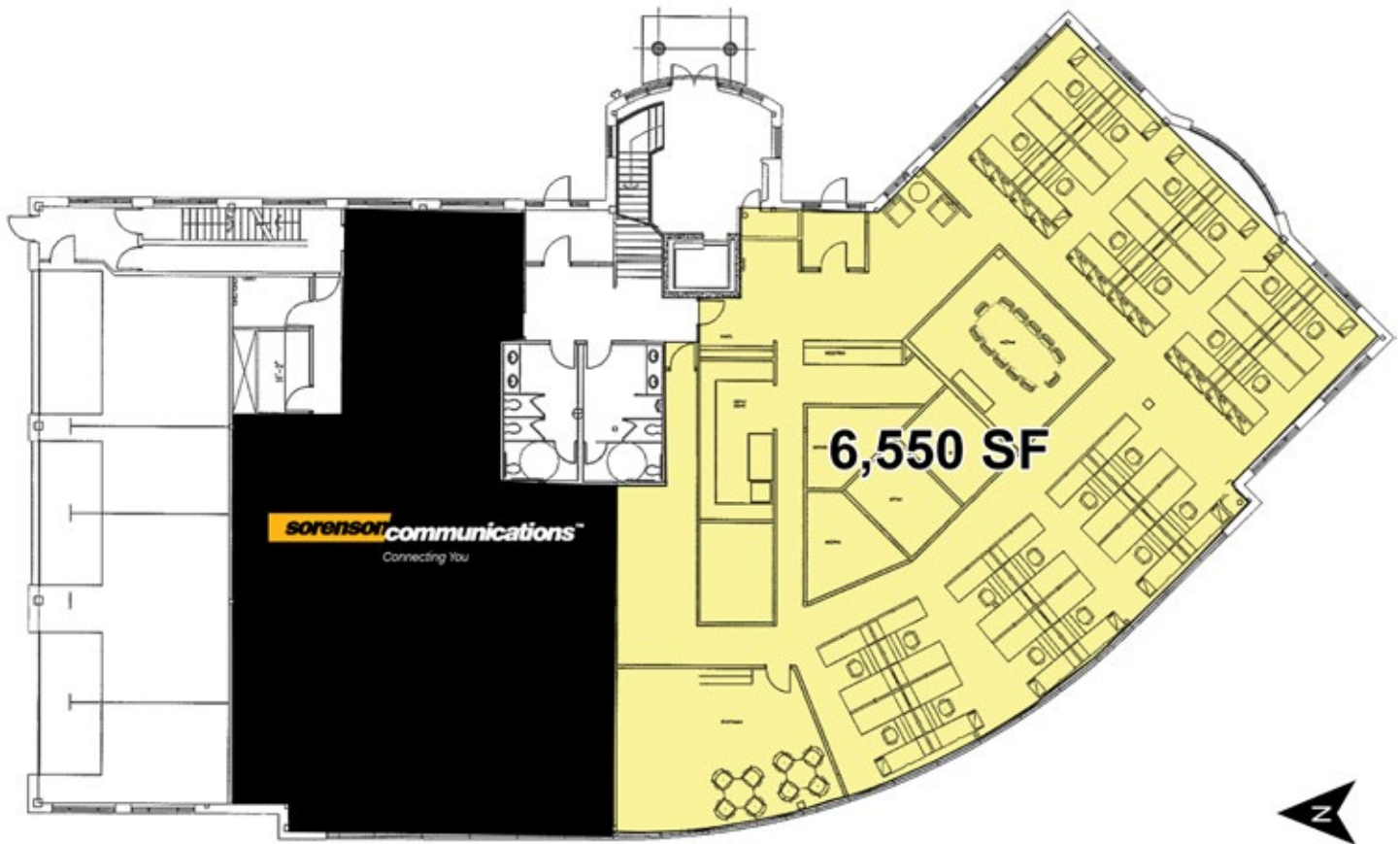

## SURROUNDED BY AMENITIES

- Surrounding businesses include Grant Park Festival (Sobeys), Grant Park Pavilions (Walmart), Grant Park Shopping Centre, StorageVille, Cora's Restaurant, Chamois and Tim Hortons.
- In close proximity to several recreational facilities including The Golf Dome, Taylor Tennis Club, and the Reh-Fit Centre.
- Across from Piazza De Nardi - a specialty wine and food centre.
- Surrounded by residential communities of River Heights, Tuxedo, Linden Woods Whyte Ridge, Fort Garry and Fort Rouge.
- New multi-family residential developments close-by.

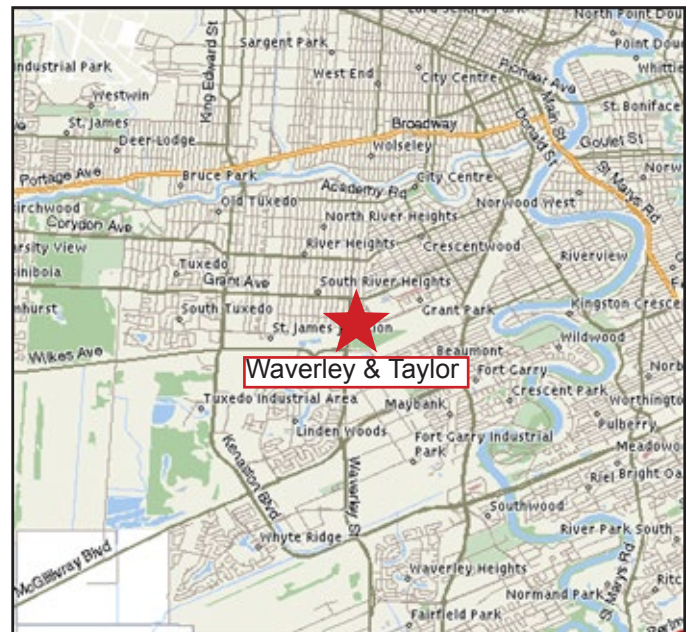

204.474.2000

**Shindico**



# MAIN FLOOR CLASS 'A' OFFICE

1355 Taylor Avenue, Winnipeg, Manitoba



## PROPERTY SUMMARY

Available (August 31, 2019)	6,550 SF
Property Taxes (est.)	\$4.59/SF
CAM* (est.)	\$4.48/SF
Parking	Available

\*plus management fee

## FEATURES

- One of **only five buildings in Manitoba** that is **BOMA BEST® Certified Gold**, the Canadian industry standard for commercial building sustainability.
- Received the **Crystal Achievement Award** for **innovative glass design**.
- **Green buildings features result in a 75% savings in utility costs.**
- Monument signage available.

## PUBLIC TRANSPORTATION

Several transit routes are nearby with stops on Taylor Avenue, Grant Avenue and Waverley Street. Phase 2 of the Southwest Transitway is just south of the building.

## TRAFFIC

54,300 vehicles per day at Waverley Street & Taylor Avenue.

(Reference: City of Winnipeg Public Works Department, 2015)



# MAIN FLOOR CLASS 'A' OFFICE

1355 Taylor Avenue, Winnipeg, Manitoba

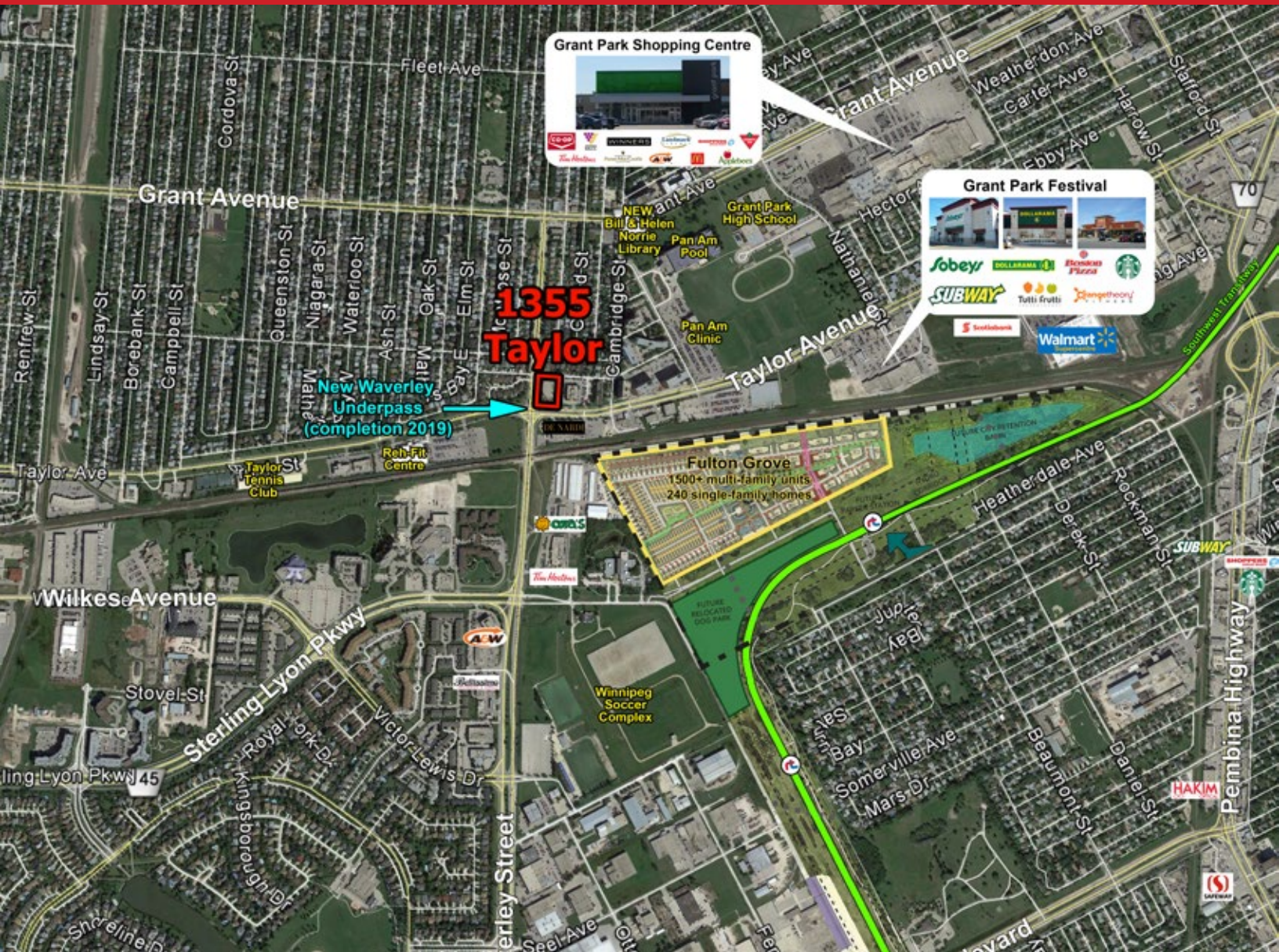

FOR MORE INFORMATION, PLEASE CONTACT:

**Sandy Shindleman, CCIM, SIOR, CRE, FRICS**  
P (204) 474-2000  
[sgshindleman@shindico.com](mailto:sgshindleman@shindico.com)

**Shindico Realty Inc.**  
200-1355 Taylor Avenue  
Winnipeg, Manitoba R3M 3Y9  
P (204) 474-2000  
[inquire@shindico.com](mailto:inquire@shindico.com)  
[www.shindico.com](http://www.shindico.com)



## Shindico

*Succeeding by Helping Others Succeed*



*Shindico is dedicated to the protection of the environment and the communities that we are a part of.*

The accuracy of the information set out herein has not been confirmed, and Shindico Realty Inc. and its affiliates make no representations or warranties as to the accuracy of the information and assumes no responsibility for errors or omissions. The recipient is responsible to verify the accuracy of any information and bears all risk related to any inaccuracies.040519