

OFFICE/RETAIL FOR LEASE

Manitoba Hydro Place Winnipeg, MB

High Traffic Office/Retail Opportunity

Chris Hourihan
Associate

T 204 934 6215
C 204 995 0225
chris.hourihan@cwstevenson.ca

Brandi Eloquence
Associate

T 204 934 6246
C 204 996 3425
brandi.eloquence@cwstevenson.ca

Murray Goodman
Senior Vice President & Principal

T 204 928 5009
C 204 990 4800
murray.goodman@cwstevenson.ca



**CUSHMAN &
WAKEFIELD**
Winnipeg



Stevenson

OFFICE/RETAIL FOR LEASE

360 Portage Avenue



(+/-) 2,588 sf Available

PROPERTY HIGHLIGHTS

- Built in 2009, Hydro Place is a 22 storey office tower and home to Manitoba Hydro's headquarters
- Skywalk connectivity, located in the heart of the SHED
- Excellent retail presence with street level exposure on Edmonton Street
- Perfect space for both office or retail tenants - Unit can be subdivided with separate entrances
- Buildout features an open workspace, 2 private offices, kitchenette and 7 kiosks
- Underground vehicle parking available at \$250/month per stall

Lease Rate: \$15.00 psf Net

CAM: \$7.65 psf (2023 est.)

ON-SITE AMENITIES

- Beautiful galleria featuring retail, office and restaurant spaces
- Rudy's Eat & Drink and Craving Curry located off the atrium
- Kitty-corner to True North Square and it's many offerings
- Underground bike storage available

SUSTAINABILITY

- LEED Platinum Certification. The most energy efficient office tower in North America and only office tower in Canada to receive LEED Platinum rating.
- Geo thermal HVAC, solar chimney, year-round 100% fresh air through computer controlled exterior building skin

OFFICE/RETAIL FOR LEASE 360 Portage Avenue



Independently Owned and Operated / A Member of the Cushman & Wakefield Alliance ©2023 Cushman & Wakefield. All rights reserved. The information contained in this communication is strictly confidential. This information has been obtained from sources believed to be reliable but has not been verified. NO WARRANTY OR REPRESENTATION, EXPRESS OR IMPLIED, IS MADE AS TO THE CONDITION OF THE PROPERTY (OR PROPERTIES) REFERENCED HEREIN OR AS TO THE ACCURACY OR COMPLETENESS OF THE INFORMATION CONTAINED HEREIN, AND SAME IS SUBMITTED SUBJECT TO ERRORS, OMISSIONS, CHANGE OF PRICE, RENTAL OR OTHER CONDITIONS, WITHDRAWAL WITHOUT NOTICE, AND TO ANY SPECIAL LISTING CONDITIONS IMPOSED BY THE PROPERTY OWNER(S). ANY PROJECTIONS, OPINIONS OR ESTIMATES ARE SUBJECT TO UNCERTAINTY AND DO NOT SIGNIFY CURRENT OR FUTURE PROPERTY PERFORMANCE.

OFFICE/RETAIL FOR LEASE 360 Portage Avenue

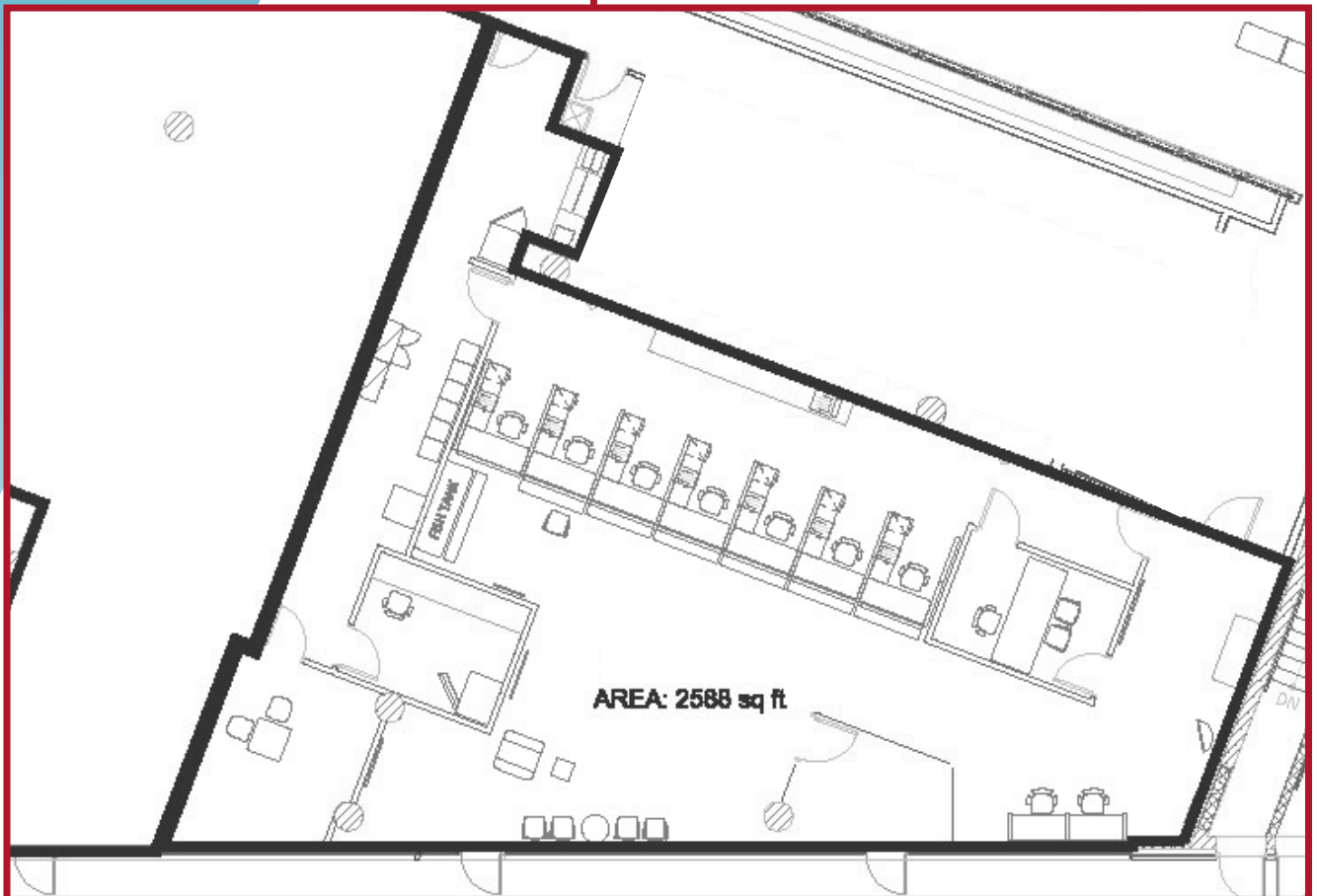
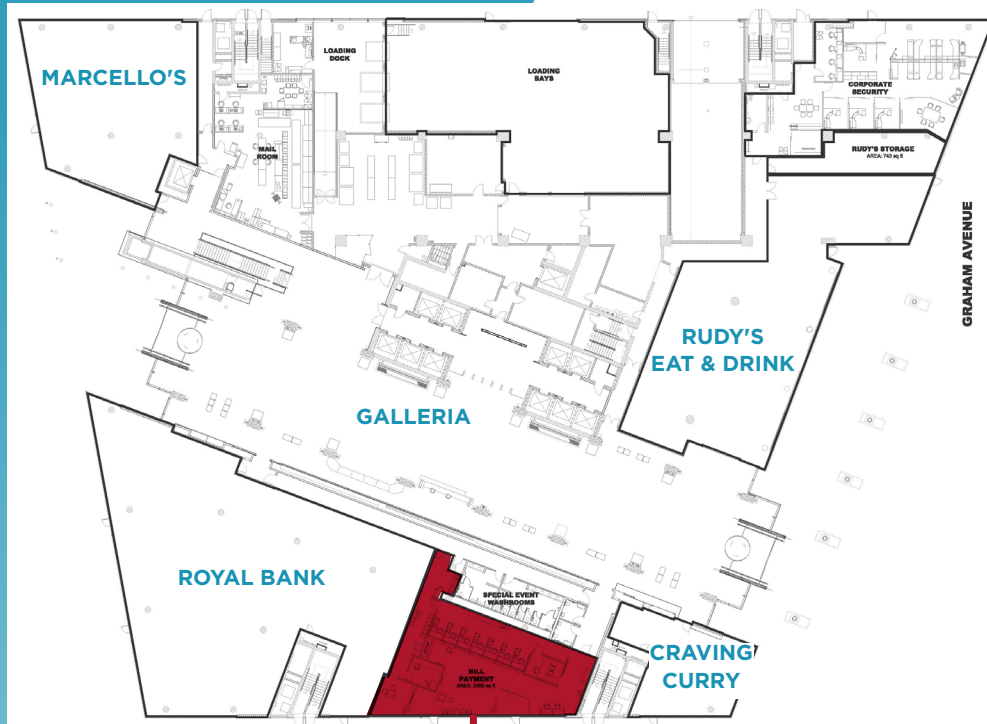

OFFICE/RETAIL FOR LEASE

360 Portage Avenue

AREA MAP



Assiniboine CREDIT UNION	Scotiabank
Mottola Grocery	
MISS BROWNS BRUNCH CAFE & SMOKED MEATS	GUSTO NORTH
THE GOOD FIGHT TACO	FH FOOLS & HORSES
SABURO RAMEN & DONBURI	YARD BURGER
	LAKE OF WOODS Brewing Company HANDCRAFTED BEER
	ROSE & BAR

Chris Hourihan
Associate

T 204 934 6215

C 204 995 0225

chris.hourihan@cwstevenson.ca

Brandi Eloquence
Associate

T 204 934 6246

C 204 996 3425

brandi.eloquence@cwstevenson.ca

Murray Goodman
Senior Vice President & Principal

T 204 928 5009

C 204 990 4800

murray.goodman@cwstevenson.ca

Independently Owned and Operated / A Member of the Cushman & Wakefield Alliance ©2023 Cushman & Wakefield. All rights reserved.
The information contained in this communication is strictly confidential.

This information has been obtained from sources believed to be reliable but has not been verified. NO WARRANTY OR REPRESENTATION, EXPRESS OR IMPLIED, IS MADE AS TO THE CONDITION OF THE PROPERTY (OR PROPERTIES) REFERENCED HEREIN OR AS TO THE ACCURACY OR COMPLETENESS OF THE INFORMATION CONTAINED HEREIN, AND SAME IS SUBMITTED SUBJECT TO ERRORS, OMISSIONS, CHANGE OF PRICE, RENTAL OR OTHER CONDITIONS, WITHDRAWAL WITHOUT NOTICE, AND TO ANY SPECIAL LISTING CONDITIONS IMPOSED BY THE PROPERTY OWNER(S). ANY PROJECTIONS, OPINIONS OR ESTIMATES ARE SUBJECT TO UNCERTAINTY AND DO NOT SIGNIFY CURRENT OR FUTURE PROPERTY PERFORMANCE.



**CUSHMAN &
WAKEFIELD**
Winnipeg



Stevenson