

**AVISON
YOUNG**

For Lease

**3605 Gilmore Way
Burnaby, BC**



The offices at 3605 Gilmore Way offer a high-quality work environment with excellent amenities for staff.

Josh Sookero*, Principal
604 647 5091
josh.sookero@avisonyoung.com
**Personal Real Estate Corporation*

Nicolas Bilodeau, Senior Vice President
604 647 1336
nicolas.bilodeau@avisonyoung.com

3605

Gilmore Way
Burnaby, BC

Property details

BUILDING CLASS

A

BUILDING AREA

47,000 sf (approx.)

LEASE RATE

Please contact listing agents

OPERATING COSTS

\$23.16 psf (2024 estimate)

TERM

5 to 10 year terms available

PARKING

2.5 stalls per 1,000 sf
Random underground = \$130
Reserved underground = \$160
Reserved Surface = \$280

ZONING

CD M8a DPK
Allows for business or professional offices as well as technological research and manufacturing

SECURITY

Proximity card system details description

Location

Located in the heart of Burnaby, 3605 Gilmore Way features a high-quality work environment complete with opening windows, bicycle storage, showers, jogging trails, tenant lounge and a large common meeting room.

Building features

 Large, ground floor common meeting room (1,600 sf) available to tenants

 Barrier-free access throughout the building

 Secure bike storage, shower and changing facilities

 Adjacent to the Gilmore Way Urban Trail with streams, walking and biking trails



New demising options available

SUITE	SIZE (sf)	DESCRIPTION
210	4,992	Two (2) offices, server room, small meeting room, reception area, boardroom, kitchenette, and open area
220	2,185	Two (2) offices, server room, reception area, kitchenette, and open area
240	2,890	Seven (7) offices, server room, reception area, boardroom, kitchenette, and open area
280	5,212	Five (5) offices, server room, reception area, boardroom, kitchenette, and open area

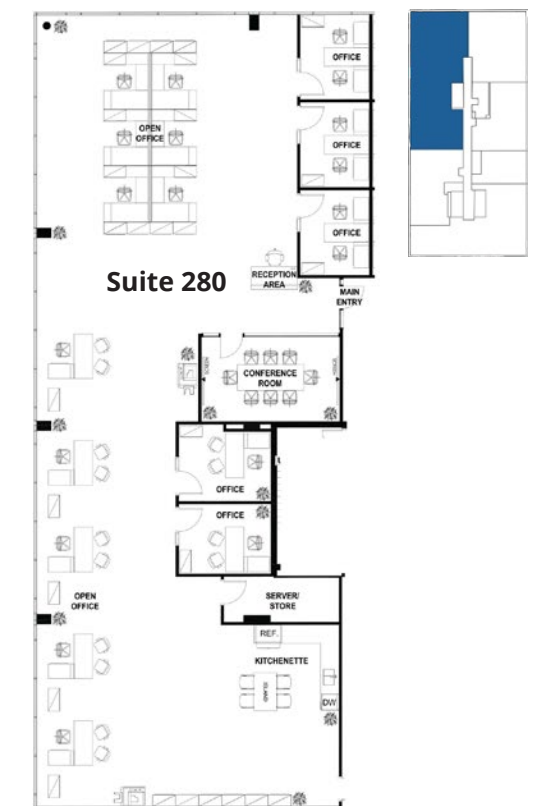
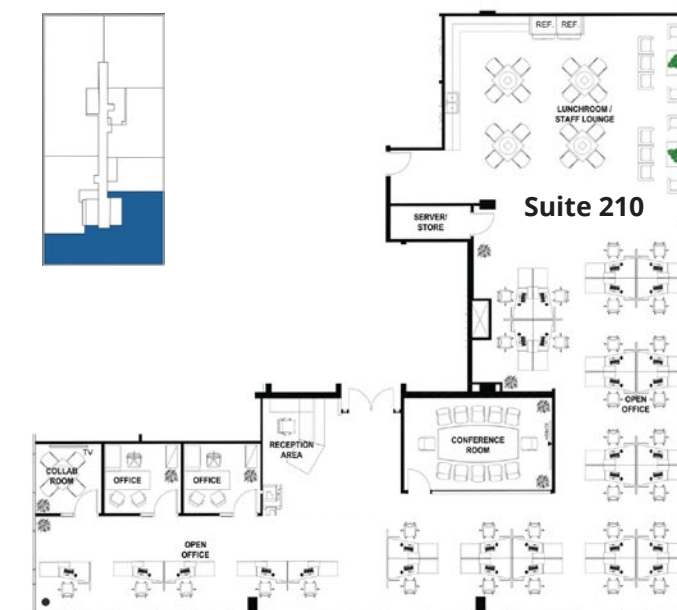

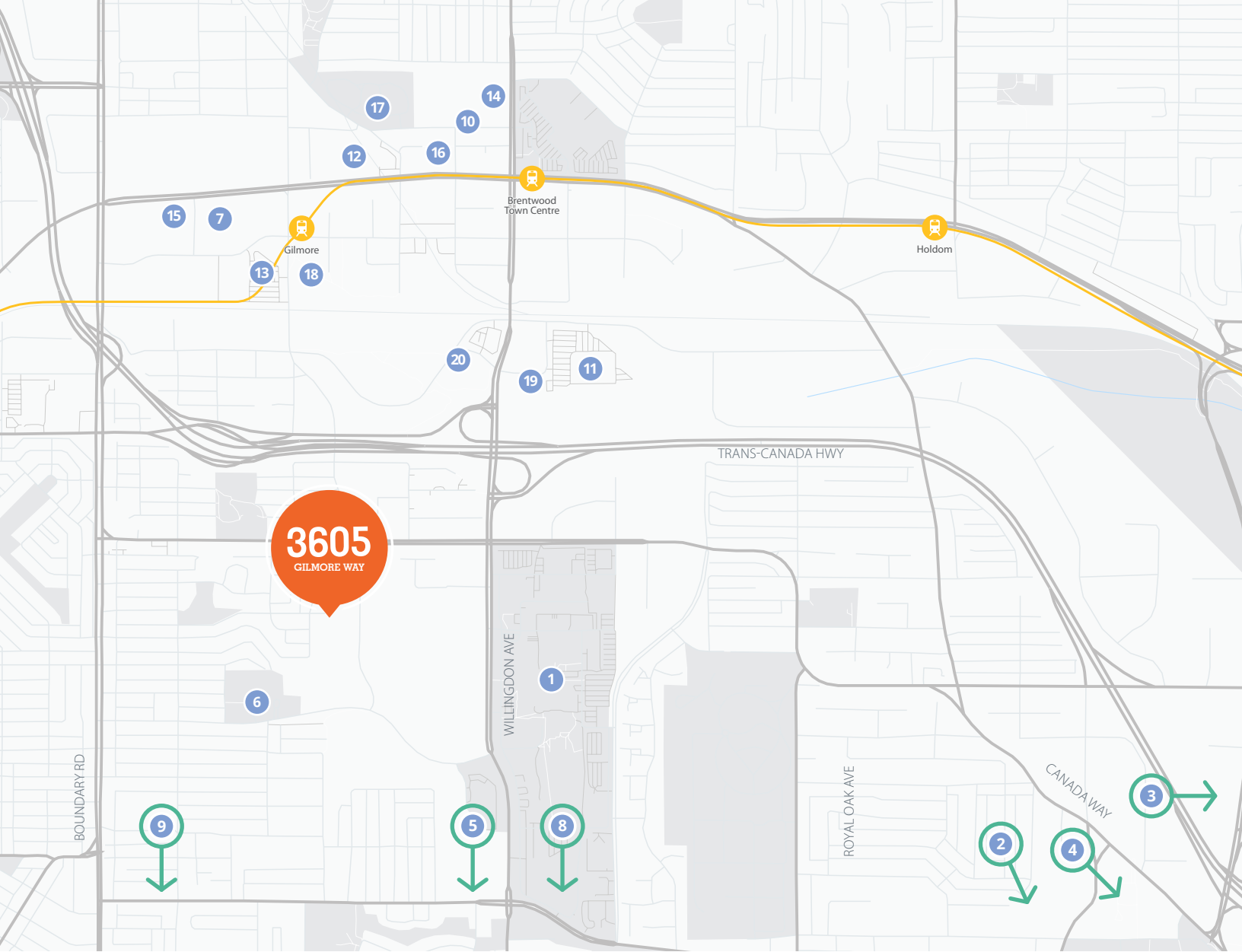

- | | | | |
|---------------------------|---------------------------|-------------------------|------------------|
| 1. BCIT | 6. Burnaby Hospital | 11. Costco Wholesale | 16. JOEY Burnaby |
| 2. Deer Lake | 7. ICBC | 12. Cactus Club Cafe | 17. Staples |
| 3. Burnaby Lake | 8. Metrotown | 13. The Home Depot | 18. Starbucks |
| 4. Burnaby Village Museum | 9. Central Park | 14. Farfalla | 19. The Keg |
| 5. Burnaby Public Library | 10. Brentwood Town Centre | 15. Earls Kitchen + Bar | 20. McDonald's |

Contact us for more information

Josh Sookero*, Principal
 604.647.5091
 josh.sookero@avisonyoung.com
**Personal Real Estate Corporation*

Nicolas Bilodeau, Senior Vice President
 604.647.1336
 nicolas.bilodeau@avisonyoung.com

**AVISON
 YOUNG**

**BEST
 MANAGED
 COMPANIES**
 Platinum member

#2900-1055 West Georgia Street
 P.O. Box 11109 Royal Centre
 Vancouver, BC V6E 3P3, Canada

avisonyoung.com