

Flex Industrial
for Lease



CBRE

520 EDINBURGH DRIVE

Moncton, New Brunswick





2,847

Available Space Sq. Ft.



Dock Level Loading



Ample On-site Parking



Signage Opportunities



Improved Office Space

PROPERTY HIGHLIGHTS

- Well-maintained flex building. Ideal for various business types.
- Located in one of the busiest Industrial Parks.
- The building offers significant exposure & visibility.
- Quick & easy access to the Trans-Canada Highway.
- Current home for various tenants such as LeafFilter Gutter Protection, Hercules SLR, Gaston's Catering, CrossFit Moncton, etc.

A perfect building for businesses to expand and thrive

Available Space	Unit 6: ±2,847 SF
Base Rent	\$12 PSF
Additional Rent	\$6.66 PSF - Utilities not included (2024 estimated)
Ceiling Height	±20' warehouse portion
Loading Doors	Unit 6: 1 dock door
Room Details	6 enclosed offices (1 data room) 1 storage room & 1 storage mezz 1 kitchenette
Zoning	Industrial Park (IP)
Year Built	1980
Lease Type	Direct
Available	July 1st 2024

520 EDINBURGH DRIVE, MONCTON, NB

PROPERTY DETAILS

LOADING ZONE

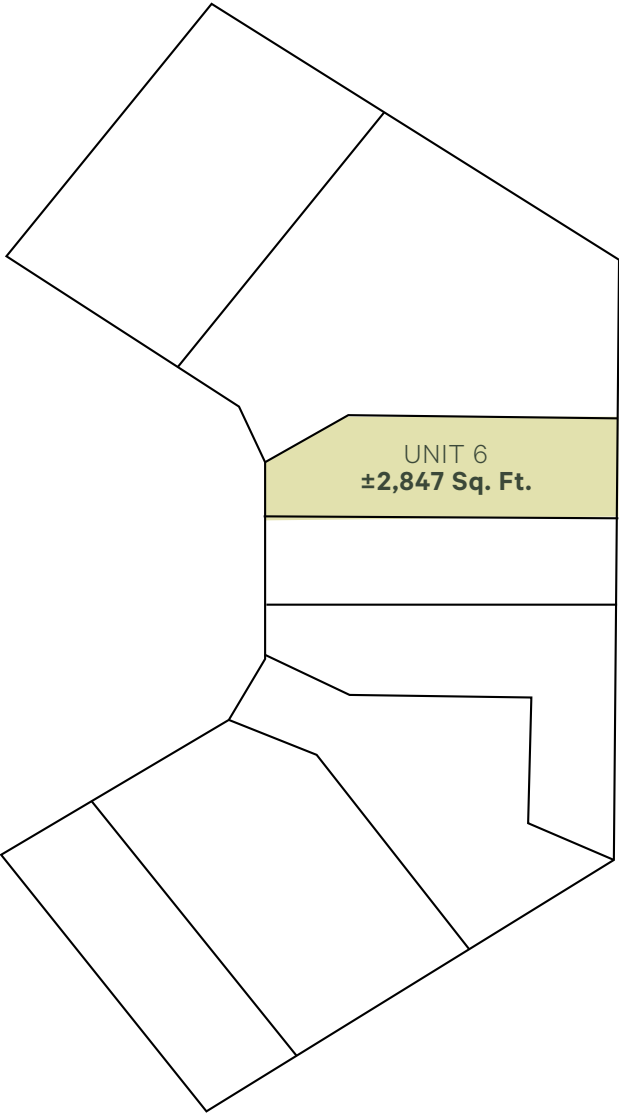

EDINBURGH DRIVE





Flex Industrial
for Lease

520 EDINBURGH DRIVE

Moncton, New Brunswick

FOR MORE INFORMATION, PLEASE CONTACT:

Sandra Paquet

Senior Sales Associate

T - 506 386 3447

sandra.paquet@cbre.com

© 2024 CBRE, Inc. All rights reserved. This information has been obtained from sources believed reliable but has not been verified for accuracy or completeness. You should conduct a careful, independent investigation of the property and verify all information. Any reliance on this information is solely at your own risk. CBRE and the CBRE logo are service marks of CBRE, Inc. All other marks displayed on this document are the property of their respective owners, and the use of such logos does not imply any affiliation with or endorsement of CBRE. Photos herein are the property of their respective owners. Use of these images without the express written consent of the owner is prohibited. Mapping Sources: Canadian Mapping Services canadamapping@cbre.com; DMTI Spatial, Environics Analytics, Microsoft Bing, Google Earth



CBRE

