

FOR LEASE | RETAIL & OFFICE



# 500 Mapleton Road

MONCTON | NEW BRUNSWICK



**CBRE**

# Property HIGHLIGHTS

500 Mapleton Road is a high-profile building located in the center of Moncton’s major retail node. The building offers impressive signage opportunity on busy Mapleton Road traveled by over 38,000 cars daily<sup>1</sup>.

**SIZE:** ±1,170 – ±2,340 SQ. FT.  
**NET RENT:** BY NEGOTIATION  
**2025 CAM & TAXES:** \$12.85\* PSF



**Built in 2009**  
Energy efficient design



**Class A**  
Professional tenancy



**High Exposure**  
Signage and pylon



**Abundant Free Parking**  
Over 140 stalls

UNIT	AVAILABILITY	RENTABLE AREA	FRONTAGE	DETAILS
130	Now	±2,340 sq. ft.	±30'	Private entrances off the parking lot. Notable retail front of ±30'. Ceiling height ±8.5' - 10.5'. One wheelchair accessible washroom and one small washroom. Subject to Landlord's approval. Unit can be subdivided.
130A	Please Contact	±1,170 sq. ft.	±15'	Subdivision scenario, subject to Landlord's approval.
130B	Please Contact	±1,170 sq. ft.	±15'	Subdivision scenario, subject to Landlord's approval.

*\*HST, Utilities, Cleaning, Telecommunications & Security charges not included*

*<sup>1</sup>Traffic Counts by City of Moncton (2023), corner of Mapleton Road, Trinity Drive and Wheeler ramps*

# Floor plan BUILDING

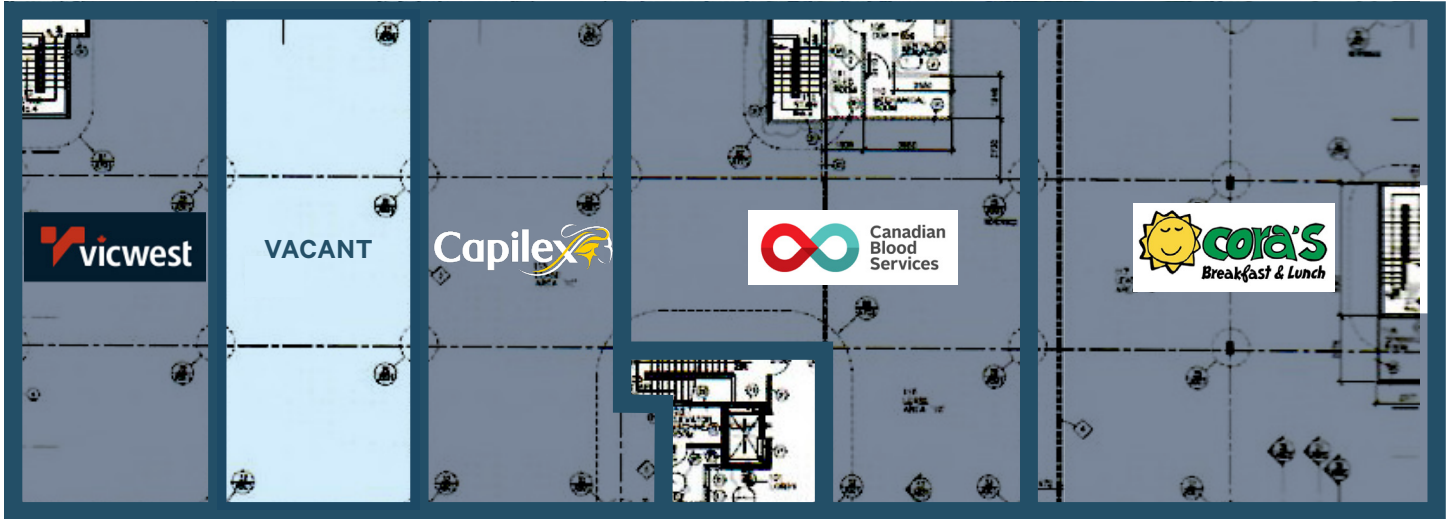

First Floor



Second Floor

# Floor plan

## UNIT 130

### Existing Improvements

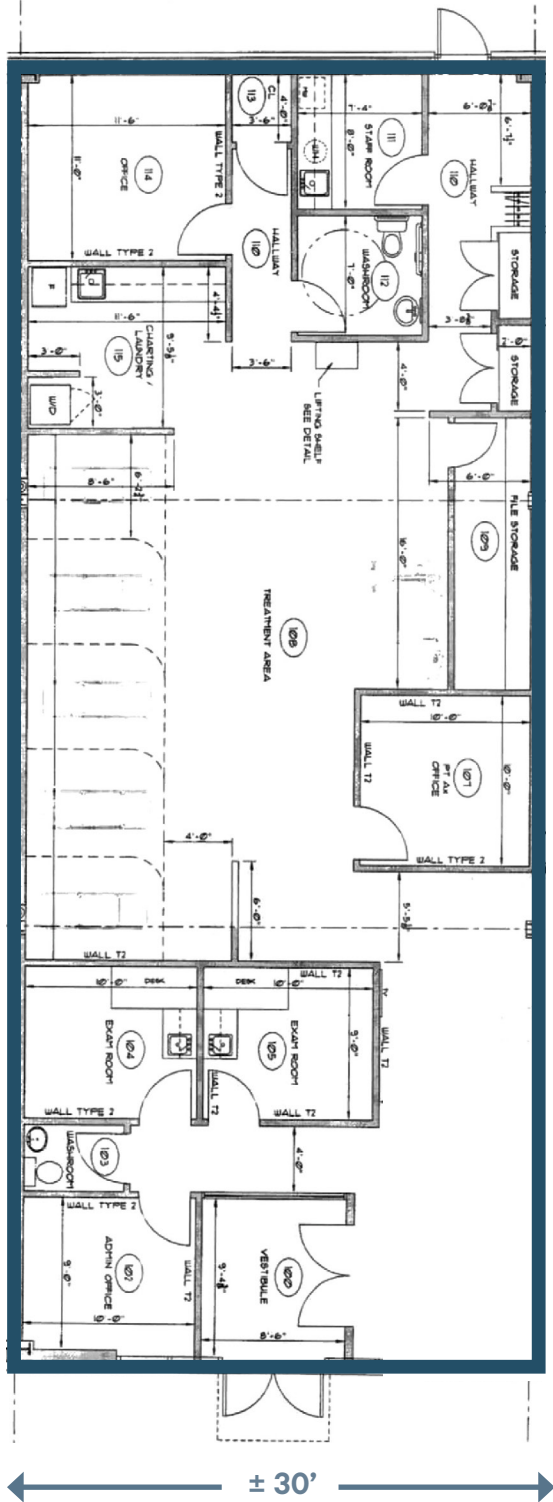

### Subdivision Scenario

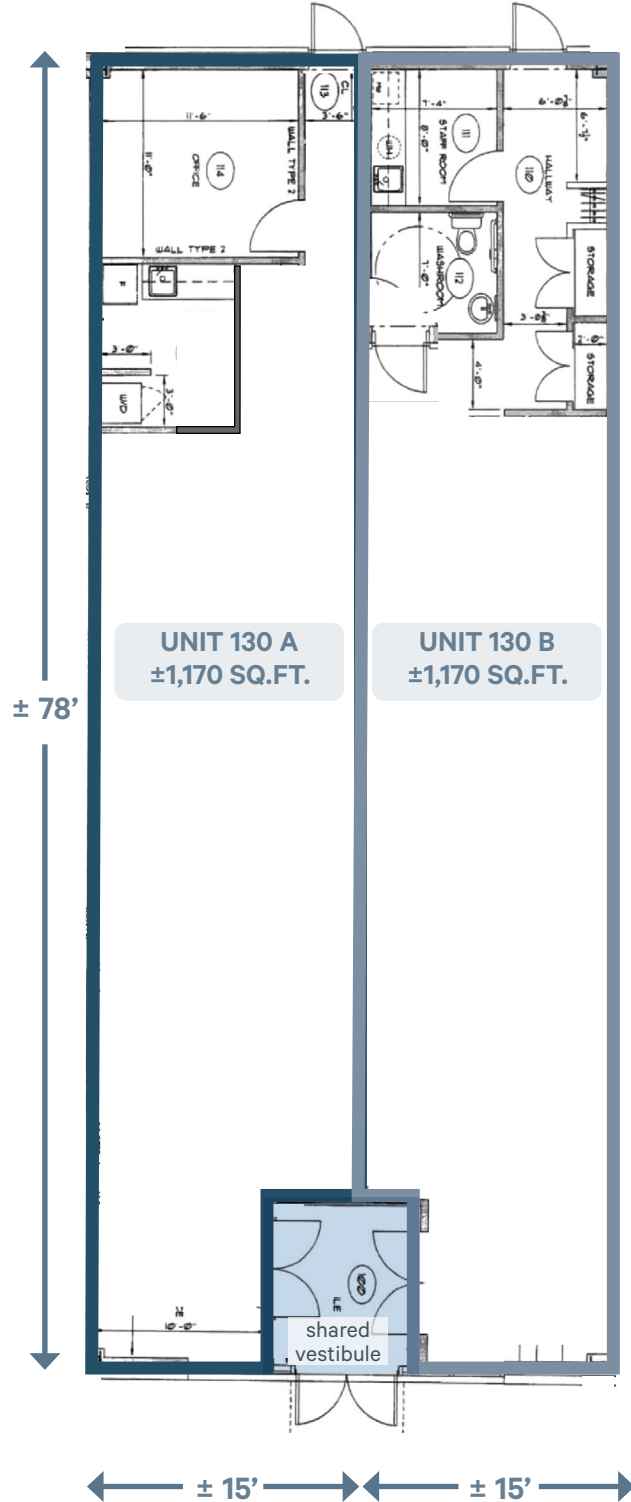

The subdivision plan shown is for illustration purposes only

# Location HIGHLIGHTS

The location provides tremendous accessibility, located only minutes away from Trans-Canada Highway and Wheeler Boulevard (Hwy 15). Existing Tenants includes: Harvest Medicine, Canadian Blood Services, Cora's Breakfast and Lunch & Iconic Smiles.

<sup>2,3</sup>Traffic Counts by City of Moncton (2021), (2023)

## Traffic Counts

- 1 27,290  
Corner of Mapleton Road, Frampton Lane, and Wyse Street (2021)<sup>2</sup>
- 2 38,147  
Corner of Mapleton Road, Trinity Drive, and Wheeler ramps (2023)<sup>3</sup>



# Mapleton - The Desirable Neighbourhood

## AVE. DRIVE TIME FROM 500 MAPLETON ROAD

Mapleton Park	2 mins
Mapleton Trinity Center	2 mins
Wheeler Park Power Centre	3 mins
Plaza Blvd Centre	4 mins
Mapleton Shopping Area	5 mins
The Moncton Hospital	8 mins
Costco Wholesale	10 mins



## Renowned Nearby Brands



And many more...

# Market SNAPSHOT

## Moncton - The “Hub City”

- The **largest metropolitan area** in New Brunswick and the second largest CMA in the Maritime provinces.
- Greater Moncton has leveraged itself into becoming a leading distribution, logistic and retail center for New Brunswick.
- The economy is largely driven by service and manufacturing industries, as well as government and professional offices choosing Moncton as their headquarters.



## Mapleton Area

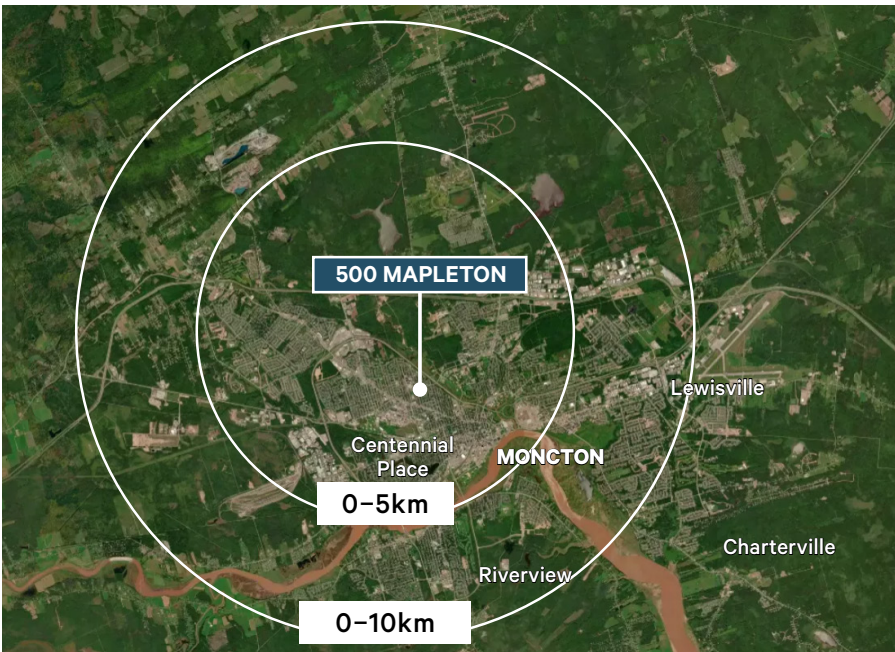

### POPULATION SNAPSHOT

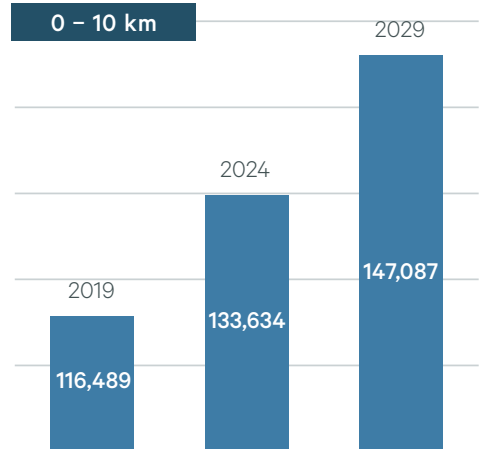
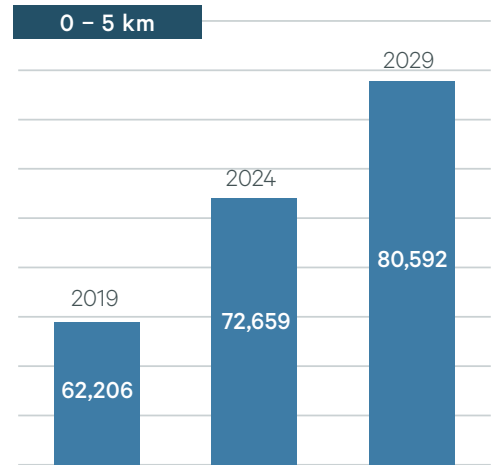

### DEMOGRAPHIC SNAPSHOT

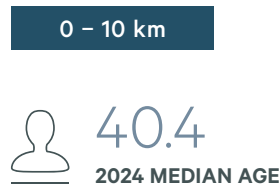
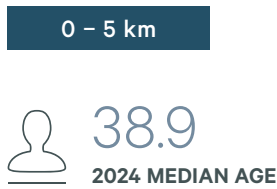

Source: StatCan, SiteWise

# Moncton Demographic Maps

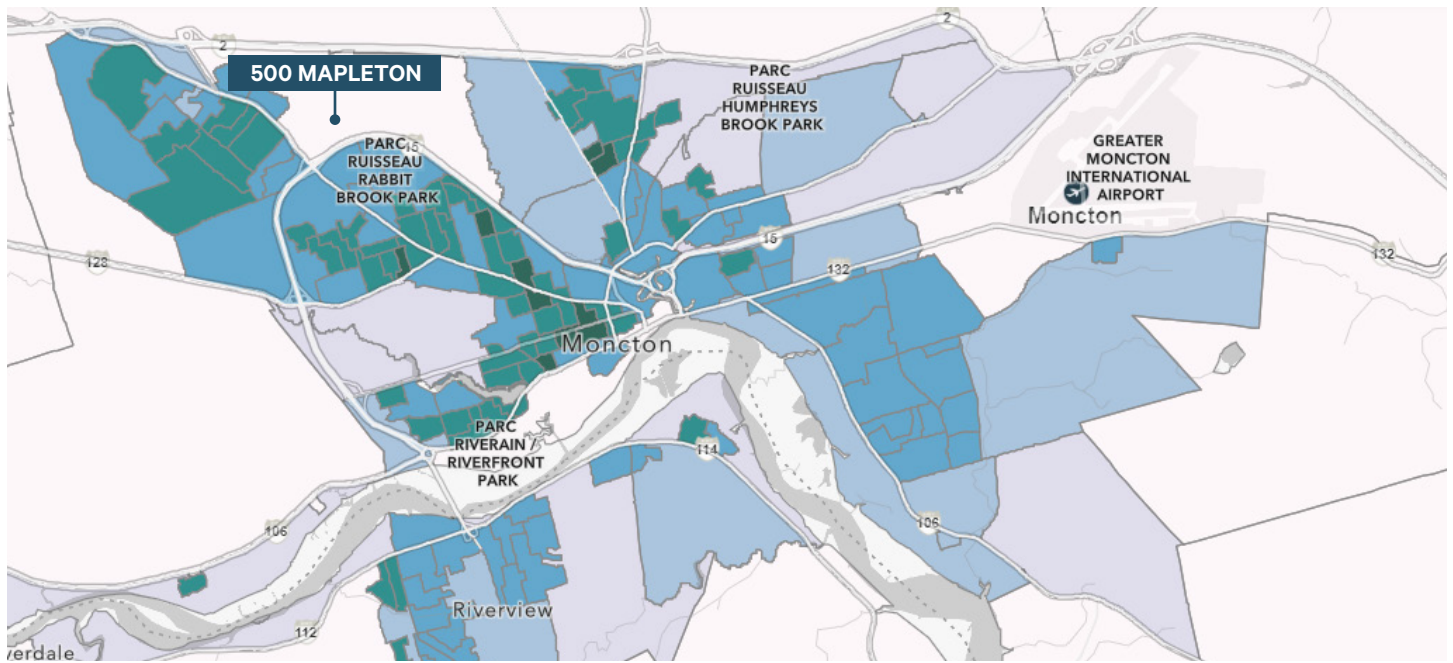

2023 POPULATION DENSITY (PERSONS PER 1 SQ. KM)

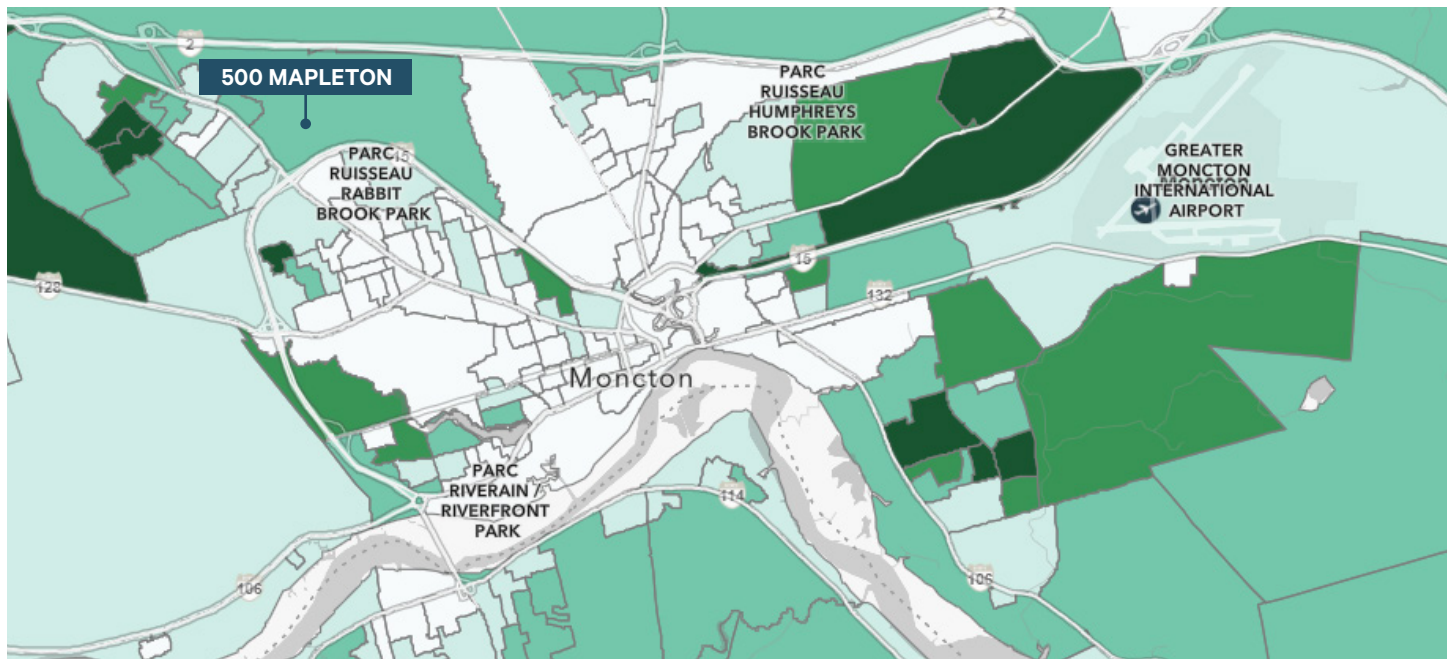
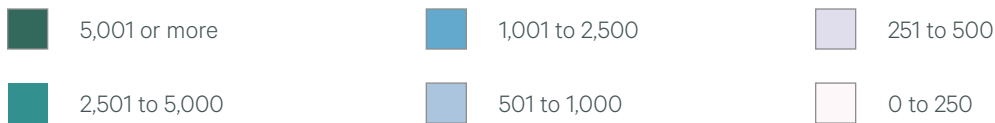

2022 AVERAGE HOUSEHOLD INCOME

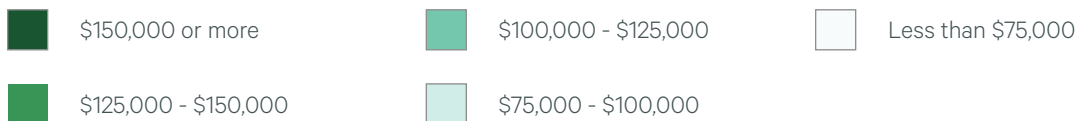





# 500 Mapleton Road

MONCTON, NEW BRUNSWICK

Please Contact:

Sandra Paquet

Senior Sales Associate

506 386 3447

sandra.paquet@cbre.com



**CBRE**

© 2025 CBRE, Inc. All rights reserved. This information has been obtained from sources believed reliable, but has not been verified for accuracy or completeness. You should conduct a careful, independent investigation of the property and verify all information. Any reliance on this information is solely at your own risk. CBRE and the CBRE logo are service marks of CBRE, Inc. All other marks displayed on this document are the property of their respective owners, and the use of such logos does not imply any affiliation with or endorsement of CBRE. Photos herein are the property of their respective owners. Use of these images without the express written consent of the owner is prohibited.