

CENTRAL YALETOWN LOCATION

Suite 450-1122 Mainland Street
Vancouver, BC



LOCATION

Located in the heart of trendy Yaletown at the corner of Mainland and Helmcken. The building offers excellent access to award-winning restaurants, the Opus Hotel and retail shopping. The property is located one block from the new SkyTrain route.

Jeff French

604.608.5968

jeff.french@ca.cushwake.com

Mark Trepp

Personal Real Estate Corporation

604.640.5820

mark.trepp@ca.cushwake.com



FOR SUBLEASE

Suite 450-1122 Mainland Street Vancouver, BC

AVAILABLE

May 1st, 2011

FEATURES

- Fully renovated office building
- Security card access & entry phone system
- Opening windows & air conditioning
- Underground parking
- Central Yaletown location
- Exposed back and beam construction

TAXES & OPERATING COSTS

\$13.00 psf, pa (2010 estimate) excluding in suite hydro and janitorial

RENTAL RATE

Negotiable

TERM

Sublease term expires April 29, 2013

AVAILABLE AREA

Suite 450 - 2,025 sf

Improved space with (2) offices, boardroom, kitchen, storage, server, and open area.

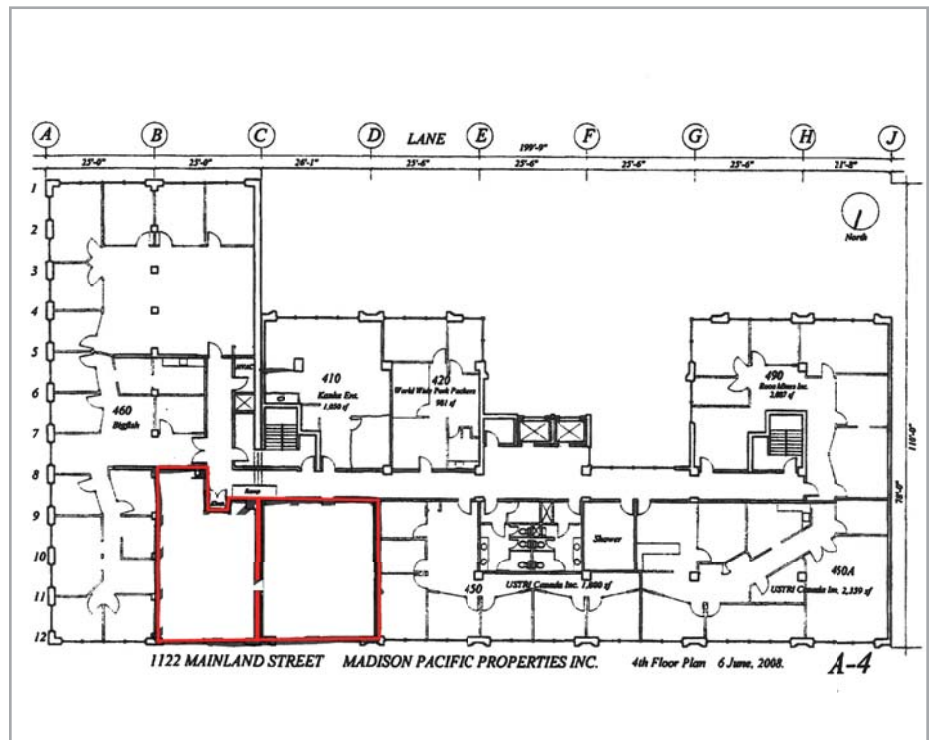

Jeff French

604.608.5968

jeff.french@ca.cushwake.com

Mark Trepp

Personal Real Estate Corporation

604.640.5820

mark.trepp@ca.cushwake.com

Cushman & Wakefield Ltd.
Suite 700 - 700 West Georgia Street
P.O. Box 10023, Pacific Centre
Vancouver, BC V7Y 1A1
T: 604.683.3111
F: 604.683.0432
www.cushmanwakefield.com
www.vancouverlisting.ca

