



155-165 AVE LABROSSE POINTE-CLAIRE, QUÉBEC

INDUSTRIEL - À LOUER
INDUSTRIAL - FOR LEASE

JUSQU'À 29 685 PI. CA. - UP TO 29 685 SQ. FT.

- **4 quais de chargement couverts** | 4 loading docks
- **4 portes au sols** | 4 drive-in
- **18' de hauteur libre** | 18' of clear height
- **Zone d'expédition/réception** | Efficient shipping/receiving area
- **Situé proche d'autoroute 40** | Located close to highway 40



BRASSWATER

245, avenue Victoria,
Suite 801
Westmount, Qc | H3Z 2M6

T: +1 514 535 4444
www.brasswater.ca

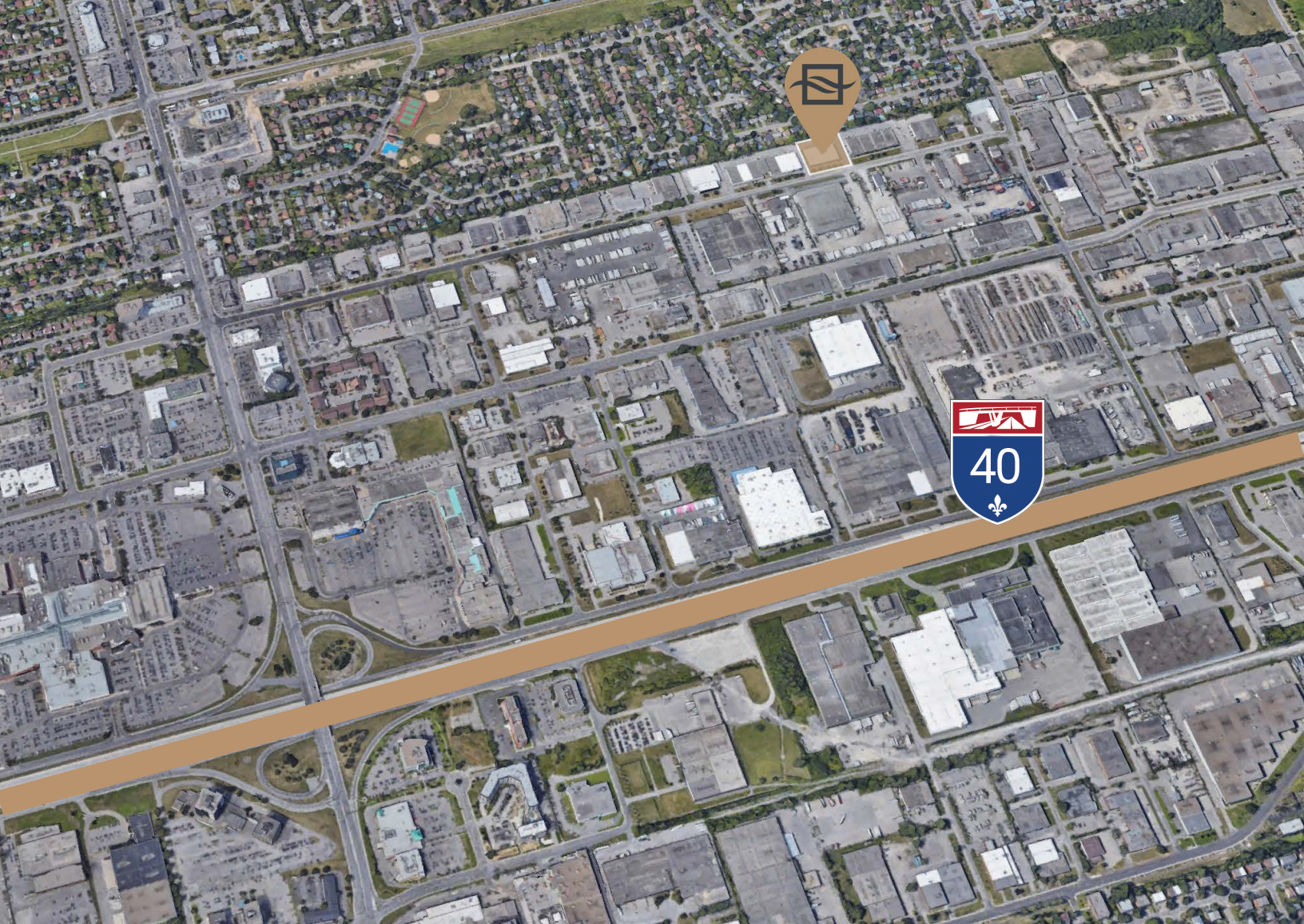

Réseau
express
métropolitain



ACCÈS FACILE À L'AUTOROUTE



EASY HIGHWAY ACCESS

SERVICES ET COMMODITÉS | SERVICES AND AMENITIES

BANQUES | BANKS

TD BANK
HSBC BANK

RESTAURANTS

STARBUCKS
MCKIBBINS
TIM HORTONS
MCDONALDS
AMIR

COMMERCE | SHOPS

FAIRVIEW POINTE-CLAIRE
TOYS R US
COSTCO
MAXI

ESPACE TOTAL - TOTAL SPACE

29 685 PI. CA.

- Quai de chargement
- porte au sol

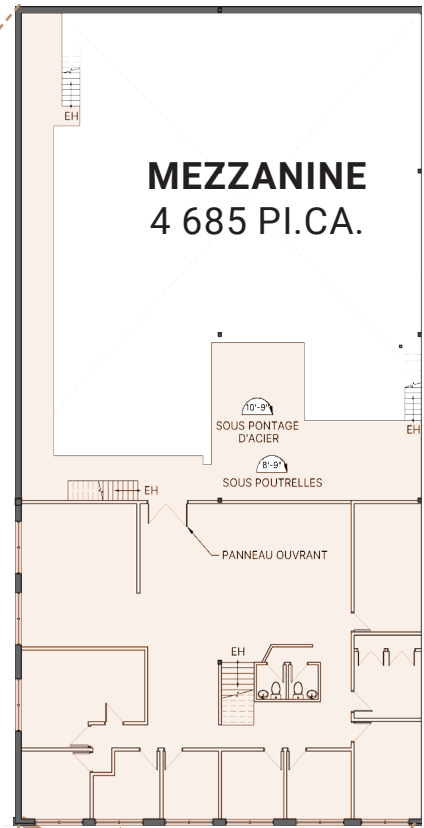

RDC
25 000 PI. CA.

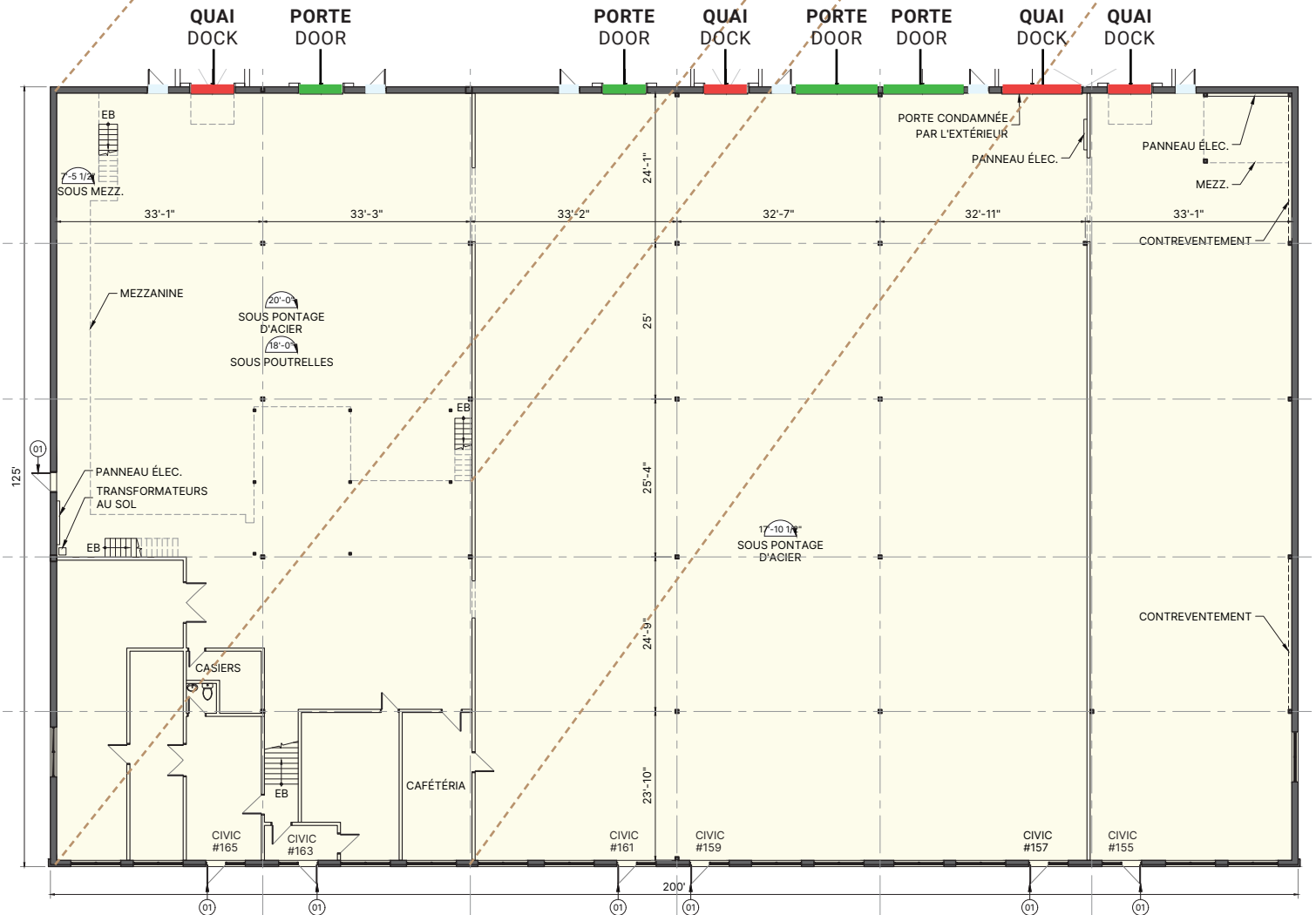

**QUAI DE CHARGEMENT
LOADING DOCK**



**PORTE AU SOL
DRIVE-IN**

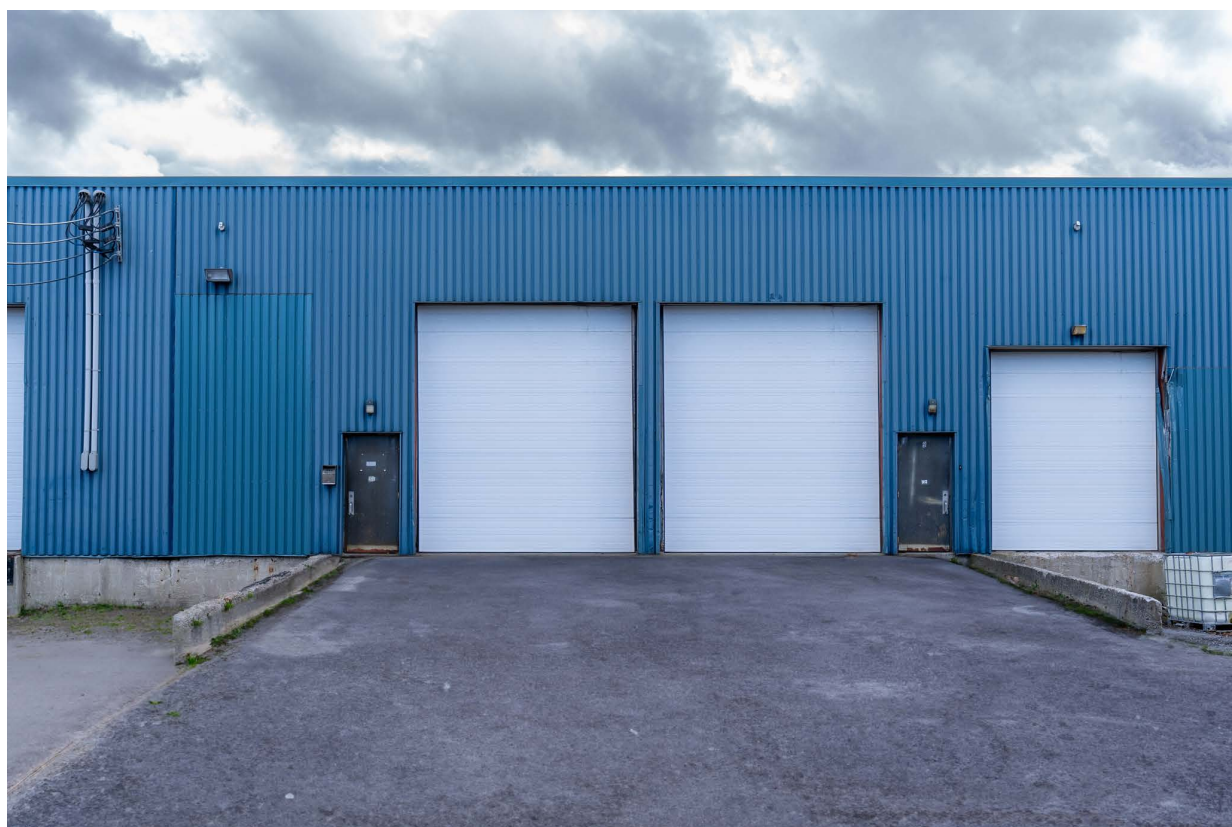

ENTREPÔT INTÉRIEUR
INTERIOR WAREHOUSE





CONTACTEZ-NOUS | CONTACT US

JORDAN ALTMAN

Agent a la location
Leasing Agent

T: +1 514 775 1234
jaltman@brasswater.ca

VICTORIA TENENBOYM

Directrice principale a la location
Senior leasing director

T: +1 514 894 6505
vtenenboym@brasswater.ca

ÉQUIPE DE LOCATION LEASING TEAM

T: +1 514 535 4444
leasing@brasswater.ca



BRASSWATER

245, avenue Victoria,
Suite 801
Westmount, Qc | H3Z 2M6
T: +1 514 535 4444
www.brasswater.ca