

6,466 SQ. FT. AVAILABLE FOR IMMEDIATE OCCUPANCY

FOR LEASE



# 16 Strathearn Avenue

Units 6-7  
Brampton, ON

**Jeff Hord\***  
Senior Vice President  
416 798 6258  
jeff.hord@cbre.com

**Kylie Rajic**  
Sales Representative  
416 798 6253  
kylie.rajic@cbre.com

**CBRE**





## PROPERTY DETAILS

<b>SIZE</b>	6,466 Sq. Ft.
<b>OFFICE</b>	5%
<b>CLEAR HEIGHT</b>	15'
<b>SHIPPING</b>	2 T/L
<b>HEAT</b>	Gas Forced Air Open
<b>POSSESSION</b>	Immediate
<b>NET RENT</b>	\$16.75 Per Sq. Ft.
<b>TMI (2024)</b>	\$5.25 Per Sq. Ft.

## COMMENTS

- Small bay unit with truck level shipping
- Centre ice Dixie & Steeles location
- New asphalt recently completed
- Great accessibility to major highways and area amenities
- Ideally suited for distribution, warehousing, or light manufacturing
- No automotive uses, recreational uses, or places of worship permitted by the Landlord

# FLOOR PLAN

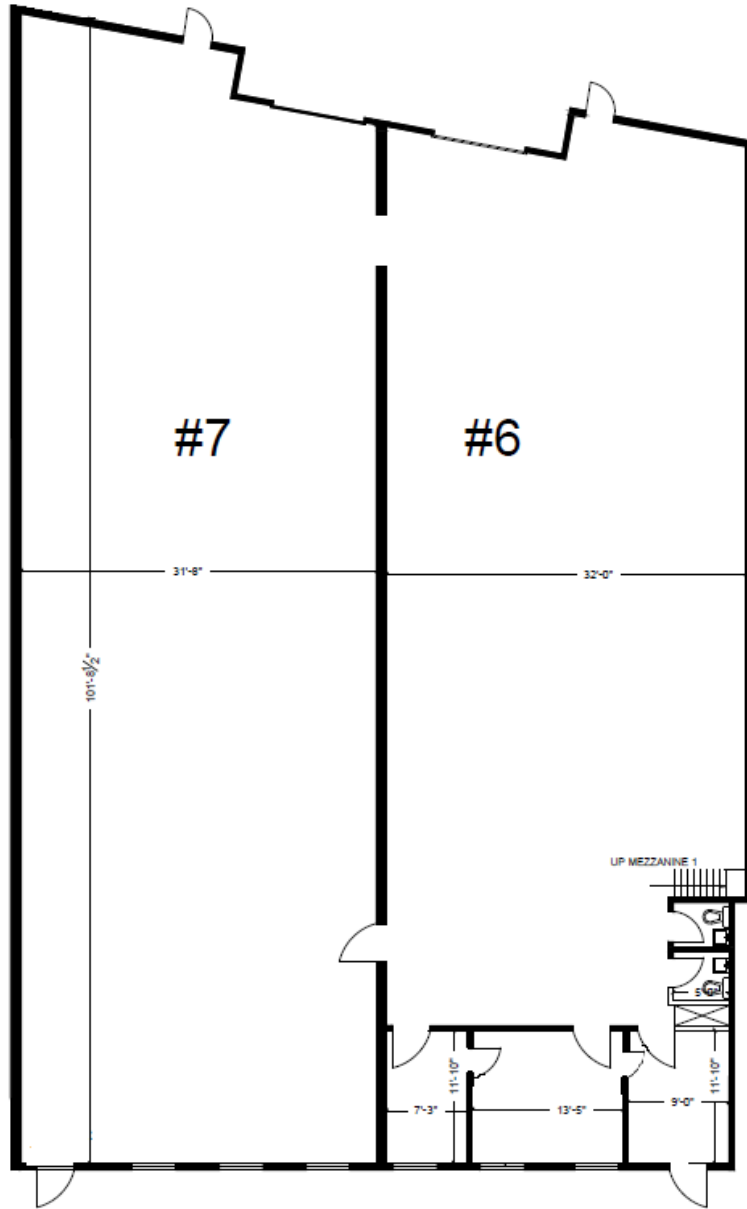

## MEZZANINE

**UNIT 6**  
474 SQ. FT.

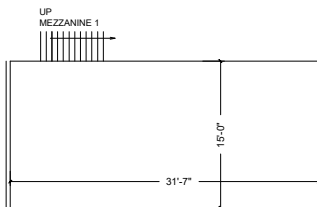



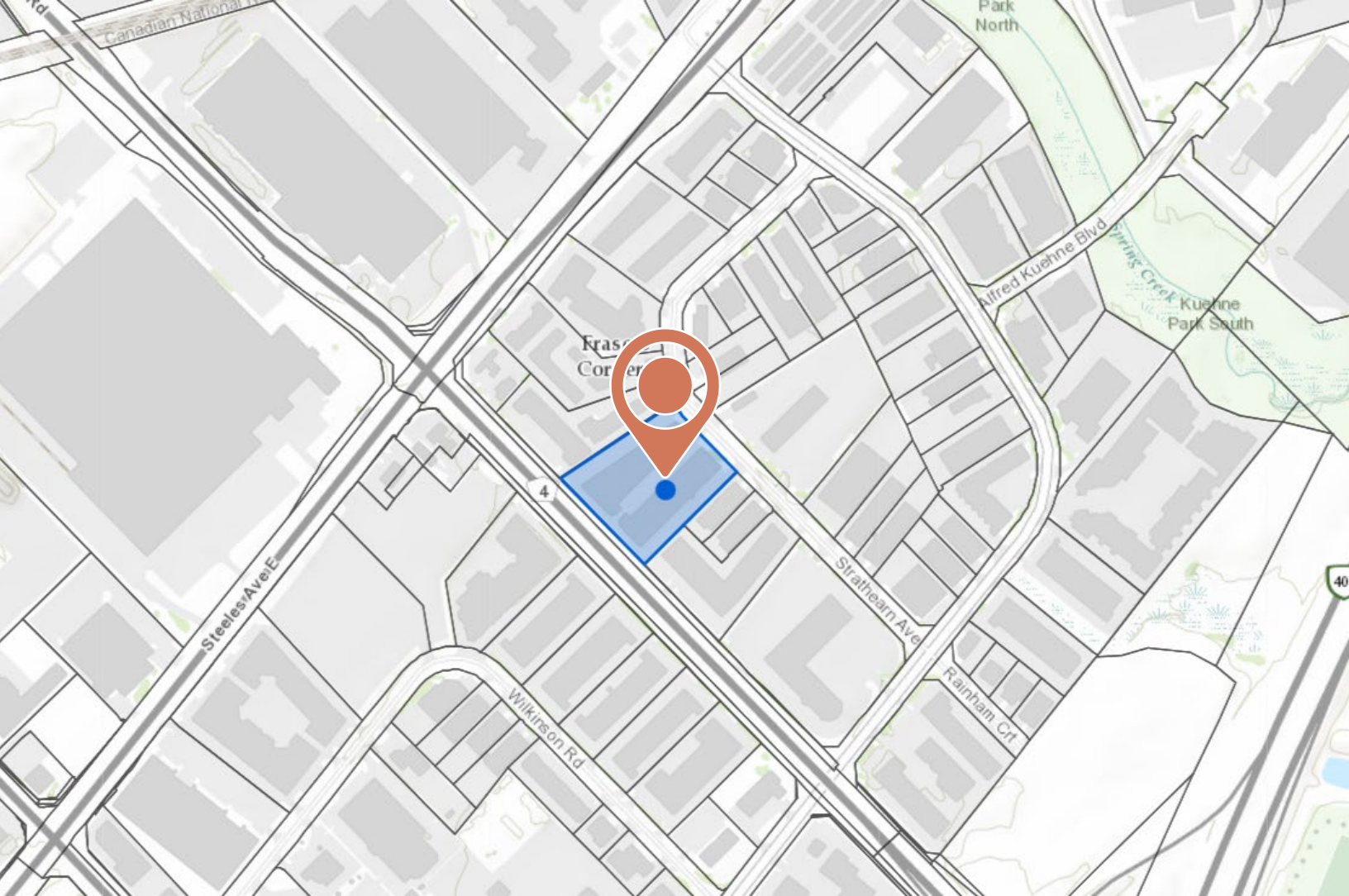

# PROPERTY ZONING

## M1 Permitted Uses<sup>(t)</sup>:

Click [HERE](#) For More Zoning Information

### INDUSTRIAL

- » The manufacturing, cleaning, packaging, processing, repairing, or assembly of goods, foods or materials within an enclosed building, including a motor vehicle repair shop, but extending a motor vehicle body shop as a principle or accessory use
- » A printing establishment
- » A warehouse
- » A parking lot

### NON-INDUSTRIAL

- » A radio or television broadcasting and transmission establishment
- » A furniture and appliance store
- » A recreational facility or structure

- » A community club
- » An animal hospital
- » A place of worship only within areas shown on Schedules G, H, and I

### ACCESSORY

- » An associated educational use
- » An associated office
- » A retail outlet operated in connection with a particular purpose permitted by the Industrial uses above provided that the total gross commercial floor area of the retail outlet is not more than 15% of the total gross industrial floor area of the particular industrial use
- » Purposes accessory to the other permitted uses



16 Strathearn Avenue | Brampton, ON

**TRANSIT**

- Bramalea GO Station
- Brampton Bus Route 18 - Dixie
- Brampton ZUM Express Bus Route 511 - Steeles
- Brampton Bus Route 11 - Steeles
- Brampton Bus Route 13 - Avondale
- Brampton Bus Route 15 - Bramalea
- Brampton Bus Route 16 - Southgate
- Brampton Bus Route 185 - Dixie Express
- Brampton Bus Route 40 - Central Industrial

# 16 STRATHEARN AVE, UNIT 6-7, BRAMPTON, ON

## Contact Us

**Jeff Hord\***  
 Senior Vice President  
 416 798 6258  
 jeff.hord@cbre.com

**Kylie Rajic**  
 Sales Representative  
 416 798 6253  
 kylie.rajic@cbre.com

5935 Airport Road, Suite 700, Mississauga, ON L4V 1W5 | \*Sales Representative

This disclaimer shall apply to CBRE Limited, Real Estate Brokerage, and to all other divisions of the Corporation; to include all employees and independent contractors ("CBRE"). All references to CBRE Limited herein shall be deemed to include CBRE, Inc. The information set out herein, including, without limitation, any projections, images, opinions, assumptions and estimates obtained from third parties (the "Information") has not been verified by CBRE, and CBRE does not represent, warrant or guarantee the accuracy, correctness and completeness of the Information. CBRE does not accept or assume any responsibility or liability, direct or consequential, for the Information or the recipient's reliance upon the Information. The recipient of the Information should take such steps as the recipient may deem necessary to verify the Information prior to placing any reliance upon the Information. The Information may change and any property described in the Information may be withdrawn from the market at any time without notice or obligation to the recipient from CBRE. CBRE and the CBRE logo are the service marks of CBRE Limited and/or its affiliated or related companies in other countries. All other marks displayed on this document are the property of their respective owners. All Rights Reserved. Mapping Sources: Canadian Mapping Services canadamapping@cbre.com; DMTI Spatial, Environics Analytics, Microsoft Bing, Google Earth

