

**AVISON
YOUNG**

For Lease

**8530 Roseberry Avenue
Burnaby, BC**



Avison Young is pleased to present the opportunity to lease from 8,483 sf to 109,410 sf of brand-new warehouse/ office space within South Burnaby.

Kyle S. Blyth*, Principal

604 647 5088

kyle.blyth@avisonyoung.com

**Kyle Blyth Personal Real Estate Corporation*

Ilya Tihanenoks, Principal

604 260 1869

ilya.t@avisonyoung.com

8530 Roseberry Avenue Burnaby, BC

Property details

PROPERTY ID

023-929-995

LEGAL DESCRIPTION

Parcel A, Plan LMP35517, District Lot 161 & 175, Group 1, New Westminster Land District 5187

LOADING

10 dock loading doors and 4 grade level loading doors

CEILING HEIGHT

28' clear

ZONING

M5 (Light Industrial District)

POWER

2000A-347/600V 3-phase main service from a 2,000 KVA substation

PARKING

+40 parking stalls

NET RENT

Contact listing agent

ADDITIONAL RENT

\$4.50 psf (Estimated for 2024)

COMPLETION

Q3 2024

FLOOR LOAD CAPACITY

500 lbs psf

Opportunity

Avison Young is pleased to present the opportunity to lease from 8,483 sf to 109,410 sf of brand-new warehouse/office space located in South Burnaby at 8530 Roseberry Avenue, Burnaby, BC (the "Property").

Flexible demising options to accommodate various tenant requirements

Location

The Property is located on the corner of Marine Way and Roseberry Avenue with excellent exposure and visibility. This prime location is in the heart of the industrial area of South Burnaby, British Columbia. The Property is ideally situated just off of Marine Way and only minutes from Boundary Road and Highway 91, offering quick and convenient access throughout Metro Vancouver.

Highlights

 Located across the street from a future film studio

 Proximity to Marine Way Market Crossing and the Big Bend Crossing

 Excellent corporate exposure and signage opportunities along Marine Way



Available area

	1	2	3	1-3
Warehouse	71,303	7,284	17,357	95,944
Mezzanine	-	595	-	595
Main floor office	5,750	-	-	5,750
Second floor office	6,270	-	-	6,270
Common area	-	604	247	851
Total	83,323	8,483	17,604	109,410

Unit 1 may be demised to suit

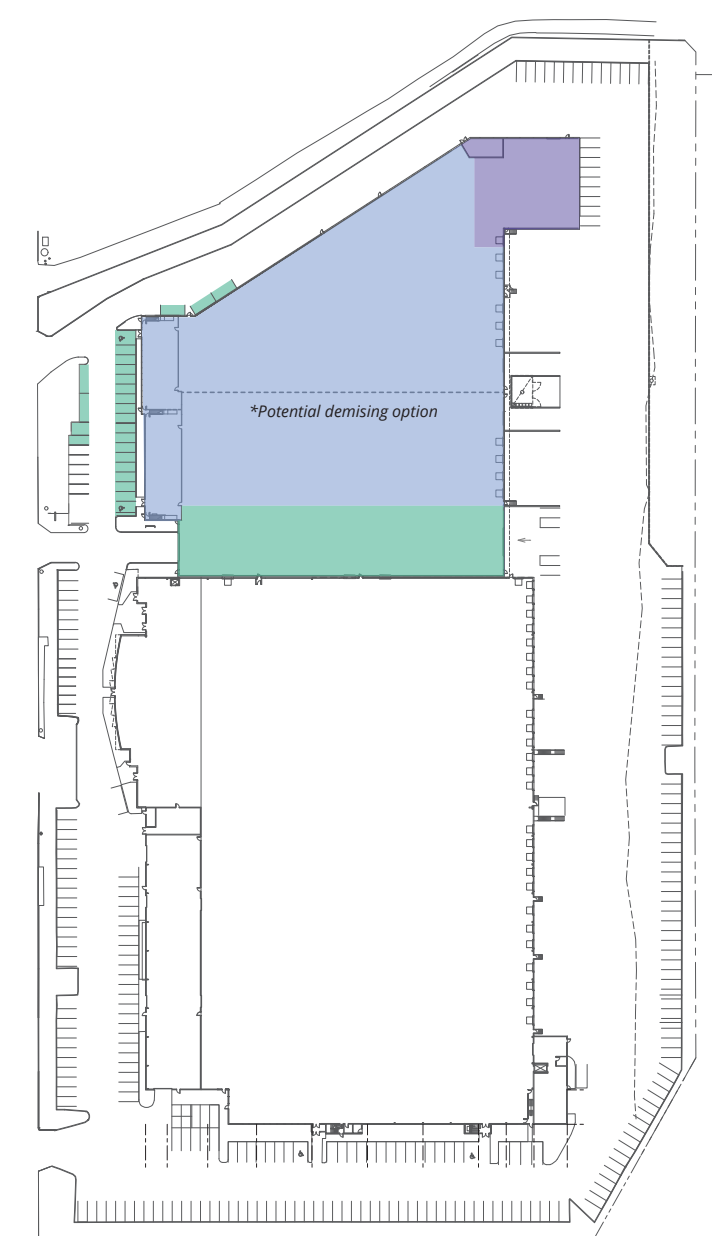

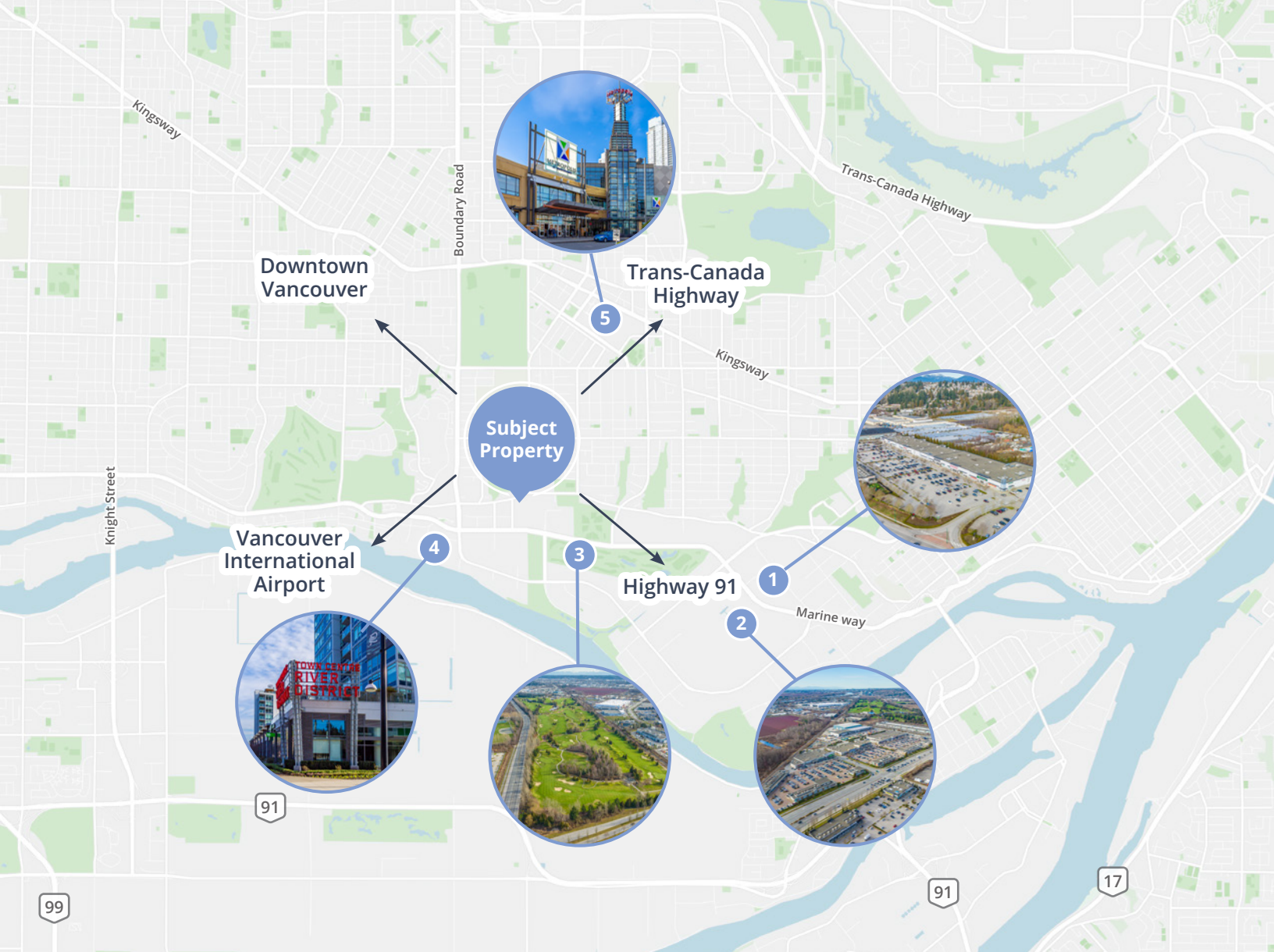

Nearby amenities

1. Big Bend Crossing
2. Marine Way Market
3. Riverway Golf Course
4. River District
5. Metrotown

Contact for more information

Kyle S. Blyth*, Principal

604 647 5088

kyle.blyth@avisonyoung.com

**Kyle Blyth Personal Real Estate Corporation*

Ilya Tihanenoks, Principal

604 260 1869

ilya.t@avisonyoung.com

**AVISON
YOUNG**

**CANADA
BEST
MANAGED
COMPANIES**

Platinum member

#2900-1055 West Georgia Street
P.O. Box 11109 Royal Centre
Vancouver, BC V6E 3P3, Canada

© 2024 Avison Young. All rights reserved. E. & O.E.: The information contained herein was obtained from sources that we deem reliable and, while thought to be correct, is not guaranteed by Avison Young Commercial Real Estate Services, LP ("Avison Young")

Website | Twitter | Instagram | LinkedIn